

CHE-601

ABSORPTION TUBE, CALCIUM CHLORIDE

Heavy Wall glass straight form with one bulb.

	Length, mm	Dia, mm
CHE-601.1	100	12
CHE-601.2	120	15
CHE-601.3	150	18



CHE-601

CHE-602

ABSORPTION TUBE, CALCIUM CHLORIDE

Heavy wall glass, U form

	Length, mm	Dia, mm
CHE-602.1	100	12
CHE-602.2	120	15
CHE-602.3	150	18



CHE-602

CHE-603

ABSORPTION TUBE, CALCIUM CHLORIDE

Heavy wall glass with side arms.

	Length, mm	Dia, mm
CHE-603.1	100	12
CHE-603.2	120	15
CHE-603.3	150	18

CHE-604

ABSORPTION TOWER, CALCIUM CHLORIDE

Capacity 250 ml glass cylindrical with socket at base for rubber stopper and glass outlet tube.

CHE-605

ASPIRATOR BOTTLE

Glass with ground stopper and tubule

	Capacity, litre
CHE-605.1	1
CHE-605.2	2
CHE-605.3	5



CHE-605

CHE-606

ASPIRATOR BOTTLE

Borosilicate glass with socket at bottom

	Capacity, ml
CHE-606.1	250
CHE-606.2	500
CHE-606.3	1000

CHE-607

ASPIRATOR BOTTLE

Borosilicate glass, with interchangeable stopper and stopcock.

	Capacity
CHE-607.1	1000 MI
CHE-607.2	2000 MI
CHE-607.3	5000 MI

CHE-608

ASPIRATOR, POLYTHENE

Rigid, with plastic screw cap, stopcock and handle.

	Capacity, litre
CHE-608.2	5
CHE-608.3	10
CHE-608.4	20



CHE-608

AUTOCLAVES

CHE-609

AUTOCLAVE GAS

Suitable for natural bottled gas. The container is made of seamless aluminium body and lid. A rubber gasket makes the lid and body airtight with help of tightening bolts and nuts. Lid is fitted with pressure gauges and double safety valve. Pressure 15 psi.

	Dia, cm	Ht, cm





CHE-609

CHE-609.1	30	30
CHE-609.2	30	38

**CHE-610
AUTOCLAVE ELECTRIC**
Made of aluminium body and lid. The lid is fitted with pressure gauge and double safety valve. Fitted with 2 kW heater. Pressure 15 psi.

	Dia, cm	Ht, cm
CHE-610.1	30	30
CHE-610.2	30	38

BALANCE & WEIGHTS

**CHE-611
BALANCE, PHYSICAL**
General purpose balance for student use. Cast alloy beams fitted with balancing nuts, agate bearings and knife edges. The hangers have double hooks for specific gravity experiments. Detachable nickel plated brass pans, enamelled central pillar, plumb line mounted in polished wooden case with levelling screws. Capacity 250 gm. Sensitivity 2 mg.

**CHE-612
BALANCE, CHEMICAL**
For Use in Colleges and Industrial Laboratories, Advanced beam engraved with a rider scale, for use with 10 mg rider, balancing nuts, agate bearings and knife edges fitted on a wooden board in a polished wooden case. Capacity 200 gm, sensitivity 0.5 mg.

**CHE-613
BALANCE ANALYTICAL**
Suitable for research laboratories or precision work. Short triangular beam, with rider scale. The beam supports are extended and relieve the agate knife edges when at rest. Pillar is highly finished and removable pans area suspended by stirrups from double hooks. The balance is mounted in a polished wooden case, fully glazed. Complete with rider slide, levelling screws. Capacity 200 gm, sensitivity 0.1 mg.

**CHE-614
BERANGER BALANCE**
Cast iron moulded body, Beam with central knife edge and pointer with two pans and heavy base.

	Capacity, kg
CHE-614.1	2
CHE-614.2	5
CHE-614.3	10

**CHE-615
DOUBLE BEAM BALANCE**
For Weighing upto 2 Kg. The balance has two beams with centre reading sliding masses. These weight upto 0-200 gm x 10 gm and 0-10 gm x 0.1 gm, total 210 gm. Supplementary masses extend the range to 2 kg. With spring loaded zero adjuster and magnetic damping. With stainless steel pans of 150 mm diameter.

**CHE-616
BALANCE, ELECTRONIC**
Ideal for Laboratories, offices, Industries, Auto Shut Off, Auto Calibration, Large LCD

	Capacity	Division
CHE-616.1	300 gm,	0.1 gm
CHE-616.2	500 gm	0.1 gm

**CHE-617
PLATFORM SCALE, PERSONAL WEIGHING MACHINE**
For personal weighing with Range 125 x 0.5 kg

**CHE-618
COMPRESSION BALANCE**
Wide view dial, large pan and plastic moulded body.

CHE-618.1	500 gm x 2 gm
CHE-618.2	1 kg x 5 gm

**CHE-619
BALANCE MASS SET, PHYSICAL**
Made of brass, chrome plated in case with lid complete set with forceps and light metal fractional weights.

CHE-619.1	1 mg to 50 gm
CHE-619.2	1 mg to 100 gm
CHE-619.3	1 mg to 200 gm



CHE-610



CHE-613



CHE-616



CHE-619.4	1 mg to 500 gm
CHE-619.5	1 gm to 1000 gm

**CHE-620
BALANCE MASS SET, ANALYTICAL**
Made of brass, chrome plated complete set with light alloy fractional weights 10 mg rider and forceps, in a nicely polished case.

CHE-620.1	1 mg to 50 gm
CHE-620.2	1 mg to 100 gm
CHE-620.3	1 mg to 200 gm

**CHE-621
BALANCE MASSES, INDIVIDUAL PHYSICAL**
Made of brass chrome plated.

CHE-621.1	1 gm
CHE-621.2	2 gm
CHE-621.3	5 gm
CHE-621.4	10 gm
CHE-621.5	20 gm
CHE-621.6	50 gm
CHE-621.7	100 gm
CHE-621.8	200 gm
CHE-621.9	500 gm
CHE-621.10	1000 gm

**CHE-622
BALANCE MASSES, INDIVIDUAL ANALYTICAL**
Made of brass chrome plated.

CHE-622.1	1 gm
CHE-622.2	2 gm
CHE-622.3	5 gm
CHE-622.4	10 gm
CHE-622.5	20 gm
CHE-622.6	50 gm
CHE-622.7	100 gm

**CHE-623
FORCEPS**
Brass chrome plated for lifting balance masses.

**CHE-624
LEVER BALANCE, DUAL SCALE**
Frame made of Die cast Aluminium with chromium plated parts, a simple single pan balance with two ranges 0-250 x 1 gm and 0-1000 x 5 gm. With levelling screw to set zero and a pointer for reading without parallax error. With detachable pan having a hook for experiments on specific gravity.

**CHE-625
BALANCE, TRIPLE BEAM**
Triple Beam Balance, with Single pan, to weigh up to 2610 gm. The balance has three beams with sliding masses giving weighing capacity of 610 gm which can be increased to 2610 gm with three supplementary masses. Stainless steel pan of 150 mm dia.

Beams :	0-500 x 100 gm
	0-100 x 10 gm
	0-10 X 0.1 gm

BAROMETERS

**CHE-626
BAROMETER ANEROID, DEMONSTRATION**
Graduated Dial 100 mm, from 28" to 31" and 940 to 1040 millibars, with an index pointer, demonstration type, transparent plastic case with pressure pump. For educational demonstration purpose only.

**CHE-627
BAROMETER, ANEROID WALL TYPE**
Graduated Dial 100 mm, from 28" to 31" and 940 to 1040 millibars with an index pointer, with transparent top cover mounted in plastic case 160 mm dia. Approx

**CHE-628
BAROMETER, FORTIN'S**



CHE-619



CHE-622



CHE-624



CHE-625





CHE-627

Suitable for School & College laboratories. Nominal 6 mm bore glass tube. With engine divided dual scales 675 to 820 x 1 mm Hg and 26.5 to 32.5 inch Hg. Verniers reading 0.05 mm and 0.002 inch. Mounted on polished wooden board for wall mounting, supplied without mercury.

BASINS

CHE-629

BASINS, EVAPORATING, ROUND FORM

Porcelain, round form, with lip, both side glazed.

	Dia. mm	Capacity, ml
CHE-629.1	25	8
CHE-629.2	50	20
CHE-629.3	75	100
CHE-629.4	100	175
CHE-629.5	125	450

CHE-630

BASINS, EVAPORATING FLAT FORM

Porcelain, flat form, with lip both sides glazed.

	Dia. mm	Capacity, ml
CHE-630.1	25	8
CHE-630.2	50	20
CHE-630.3	75	100
CHE-630.4	100	175
CHE-630.5	125	450

CHE-631

WATER BATH COPPER

Made of thick copper sheet, with a set of concentric rings provided with two handles.

	Dia. mm
CHE-631.1	100
CHE-631.2	125
CHE-631.3	150
CHE-631.4	200

CHE-632

WATER BATH ALUMINIUM

Made of Aluminium Sheet, with a set of concentric rings provided with two handles

	Dia. mm
CHE-632.1	100
CHE-632.2	125
CHE-632.3	150
CHE-632.4	200

CHE-633

WATER BATH

Vertical sides, fitted with concentric rings. 90 x 125 mm.

CHE-633.1	Made of Copper
CHE-633.2	Made of Aluminium

CHE-634

WATER BATH, ELECTRIC

Body Made of Aluminium, plastic feet, concentric rings with constant level device and 1 kW heater with automatic cut out. Size 145 x 200 mm. Complete with connector plug and 1 metre of 3 core cable.

CHE-635

WATER BATH, RECTANGULAR, ELECTRIC

Single wall, chamber made of stainless steel, having 75 mm holes and concentric rings at top with tubules for water level arrangement, 1 kW heater with cut-out device, Complete with connector plug and 1 metre of 3 core cable.

	Chamber size, mm
CHE-635.1	300 x 250 x 100 (6 Holes)
CHE-635.2	425 x 325 x 100 (12 Holes)

CHE-636

WATER BATH, RECTANGULAR, ELECTRIC DOUBLE WALL

Double walled inner chamber made of stainless steel, and the outer made of stove enamelled mild steel. Top has 75 mm holes with concentric rings. Temperature range upto 100° C., accuracy $\pm 1^\circ$ C., Heater fitted with automatic cut-out device, thermostat, two indicators lights, workable on 240 Volts.

	Chamber size, mm
CHE-636.1	300 x 250 x 100 (6 Holes)
CHE-636.2	425 x 325 x 100 (12 Holes)

CHE-637

WATER BATH, SEROLOGICAL

Double walled, inner chamber of stainless steel, outer made of stove enamelled mild steel, with



CHE-629



CHE-632



CHE-634



insulation in between, thermostatic temperature control from 50 C above room temperature to 950 C with accuracy $\pm 0.5^\circ$ C. Bath has a stainless steel dome cover, perforated and removable shelves, drain plug two indicator lights, thermostat control knob, heater with automatic cut out. . Works on 220-240 V 50 Hz. Supplied without racks.

	Inner chamber size, mm
CHE-637.1	300 x 250 x 175 (for 2 Racks)
CHE-637.2	325 x 300 x 175 (for 4 Racks)
CHE-637.3	450 x 300 x 175 (for 6 Racks)
CHE-637.4	600 x 300 x 175 (for 8 Racks)

CHE-638

TEST TUBE RACKS

Test Tube Racks for serological water baths.

	Tube dia, mm	No. of holes
CHE-638.1	12	55
CHE-638.2	16	36
CHE-638.3	25	18

CHE-639

WATER BATH, PRECISION

Double walled, inner chamber made of stainless steel, outer chamber made of stove enamelled mild steel with insulation in between. Temperature is controlled by thermostat from 5° C above room temperature to 95° C, $\pm 0.2^\circ$ C. Stirrer is provided for continuous stirring, and a front glass window on one side for visibility of the sample. Supplied with contact thermometer stirrer with 1/20 H.P. high speed motor and speed regulator. Works on 220-240 V, 50 Hz.

BEAKERS

CHE-640

BEAKER, LOW FORM

Glass, With spout.

	Capacity, ml
CHE-640.1	25
CHE-640.2	50
CHE-640.3	100
CHE-640.4	250
CHE-640.5	400
CHE-640.6	500
CHE-640.7	1000
CHE-640.8	2000

CHE-641

BEAKER, LOW FORM BOROSILICATE GLASS

Borosilicate Glass, With spout.

	Capacity, ml
CHE-641.1	5
CHE-641.2	10
CHE-641.3	25
CHE-641.4	50
CHE-641.5	100
CHE-641.6	250
CHE-641.7	400
CHE-641.8	500
CHE-641.9	1000
CHE-641.10	2000

CHE-642

BEAKER, LOW FORM POLYPROPYLENE

Polypropylene. With spout,

	Capacity, ml
CHE-642.1	50
CHE-642.2	100
CHE-642.3	150
CHE-642.4	500
CHE-642.5	1000

CHE-643

BEAKERS, SQUAT FORM

Autoclavable. With spout, TPX transparent plastic.

	Capacity, ml
CHE-643.1	100
CHE-643.2	250
CHE-643.3	500
CHE-643.4	1000



CHE-637



CHE-640



CHE-641



CHE-642





CHE-644

CHE-643.5 2000

CHE-644

BEAKER, TALL FORM

With spout, borosilicate glass.

Capacity, ml

CHE-644.1	100
CHE-644.2	250
CHE-644.3	500
CHE-644.4	1000

CHE-645

BEEHIVE SHELF

Porcelain, glazed inside and outside.

Capacity, ml

CHE-645.1	60
CHE-645.2	75
CHE-645.3	100

CHE-646

BELL JAR

Glass, with knob at top, ground rim.

Ht, mm Dia, mm

CHE-646.1	200	100
CHE-646.2	225	150



CHE-645

CHE-647

BELL JAR WITH GLASS STOPPER

Glass, with ground glass stopper at top, ground rim.

Ht, mm Dia, mm

CHE-647.1	200	100
CHE-647.2	225	150

CHE-648

BLOW PIPE

Brass, Nickel plated, curved head length 18 cm.

CHE-649

BOTTLE, REAGENT CLEAR GLASS WIDE MOUTH

Wide mouth, clear glass with dust proof flat stopper.

Capacity, ml

CHE-652.1	30
CHE-652.2	60
CHE-652.3	125
CHE-652.4	250
CHE-652.5	500
CHE-652.6	1000
CHE-652.7	2000



CHE-646

CHE-650

BOTTLE, REAGENT AMBER GLASS WIDE MOUTH

Wide mouth, Amber glass with dust proof flat stopper.

Capacity, ml

CHE-653.1	125
CHE-653.2	250
CHE-653.3	500
CHE-653.4	1000

CHE-651

BOTTLE, REAGENT

Polythene, narrow mouth, with screw cap.

Capacity, ml

CHE-651.1	60
CHE-651.2	125
CHE-651.3	250
CHE-651.4	500



CHE-647

CHE-652

BOTTLE, REAGENT CLEAR GLASS NARROW MOUTH

Narrow mouth, clear Glass with dust proof flat stopper.

Capacity, ml

CHE-649.1	30
CHE-649.2	60

CHE-649.3	125
CHE-649.4	250
CHE-649.5	250
CHE-649.6	1000
CHE-649.7	2000

CHE-653

BOTTLE, REAGENT AMBER GLASS NARROW MOUTH

Narrow mouth, Amber Glass with dust proof flat stopper.

Capacity, ml

CHE-650.1	30
CHE-650.2	60
CHE-650.3	125
CHE-650.4	250
CHE-650.5	250
CHE-650.6	1000

CHE-654

BOTTLE, REAGENT

Polythene, wide mouth with screw cap.

Capacity, ml

CHE-654.1	60
CHE-654.2	125
CHE-654.3	250
CHE-654.4	500

CHE-655

BOTTLE, CLEAR GLASS

Wide mouth, screw on plastic cap.

Capacity, ml

CHE-655.1	180
CHE-655.2	250
CHE-655.3	500
CHE-655.4	1000



CHE-652

CHE-656

BOTTLE, DROPPING

Clear glass bottle with rubber teat, dropping pipette grinded into bottle neck.

Capacity, ml

CHE-656.1	30
CHE-656.2	60
CHE-656.3	125

CHE-657

BOTTLE, DROPPING CLEAR GLASS T.K. PATTERN

T.K. pattern with grooved glass grip stopper and spout.

Capacity, ml

CHE-657.1	15
CHE-657.2	30
CHE-657.3	60
CHE-657.4	125



CHE-653

CHE-658

BOTTLE, DROPPING AMBER GLASS T.K. PATTERN

T.K. pattern with grooved glass grip stopper and spout.

Capacity, ml

CHE-658.1	30
CHE-658.2	60
CHE-658.3	125

CHE-659

BOTTLE, DROPPING

T.K. pattern, plastic.

Capacity, ml

CHE-659.1	30
CHE-659.2	60
CHE-659.3	125

CHE-660

BOTTLE, McCARTNEY (BIJOU) NARROW MOUTH

Narrow mouth, clear glass, with aluminium screw cap and rubber liner, autoclavable.

Capacity, ml

CHE-660.1	7
-----------	---



CHE-656



CHE-658





CHE-661

CHE-660.2 14

CHE-661
BOTTLE, McCARTNEY WIDE MOUTH
Wide mouth with aluminium cap and rubber washer autoclavable. Capacity 28 ml.

CHE-662
SPECIFIC GRAVITY BOTTLE CLEAR GLASS
Ground capillary stopper. clear glass

	Capacity, ml
CHE-662.1	25
CHE-662.2	50

CHE-663
SPECIFIC GRAVITY BOTTLE BOROSILICATE GLASS
Ground capillary stopper. Borosilicate glass

	Capacity, ml
CHE-663.1	25
CHE-663.2	50

CHE-664
WASH BOTTLE
Polythene squeeze bottle screw cap fitted with delivery tube

	Capacity, ml
CHE-664.1	125
CHE-664.2	250
CHE-664.3	500
CHE-664.4	1000

CHE-665
WEIGHING BOTTLE NEUTRAL GLASS
Tall form. Neutral glass

	Dia X Ht.
CHE-665.1	20 x 40 mm
CHE-665.2	30 x 40 mm
CHE-665.3	25 x 50 mm

CHE-666
WEIGHING BOTTLE BOROSILICATE GLASS
Tall form. borosilicate glass

	Dia x Ht.
CHE-666.1	20 x 40 mm
CHE-666.2	30 x 40 mm
CHE-666.3	25 x 50 mm

CHE-667
WEIGHING BOTTLE NEUTRAL GLASS
Squat form. Neutral glass

	Dia x Ht.
CHE-667.1	40 x 20 mm
CHE-667.2	50 x 25 mm

CHE-668
WEIGHING BOTTLE BOROSILICATE GLASS
Squat form. Borosilicate glass

	Dia x Ht.
CHE-668.1	40 x 20 mm
CHE-668.2	50 x 25 mm

CHE-669
BOTTLE STAND
Made of hardwood, for 60 ml dropping bottle.

CHE-669.1	6 holes
CHE-669.2	12 holes

CHE-670
BOTTLE RACK
Adjustable hardwood rack to hold 30 ml and 60 ml bottle Bottles are clamped to avoid their removal from rack when using pipette.

CHE-671
WOULF BOTTLE GLASS
Two Necks, glass

	Capacity
--	----------



CHE-663



CHE-664



CHE-666



CHE-671.1	250 ml
CHE-671.2	500 ml

CHE-672
WOULF BOTTLE BOROSILICATE GLASS
Two Necks, borosilicate glass

	Capacity
CHE-672.1	250 ml
CHE-672.2	500 ml

BRUSHES

CHE-673
BRUSH BEAKER
Hard nylon bristles on twisted G.I. wire head 140 x 63 mm overall length 400 mm.

CHE-674
BOTTLE BRUSH
Hard nylon bristles, mounted on twisted G.I. wire head 120 x 65 mm, overall length 500 mm.

CHE-675
BURETTE BRUSH
Hard nylon bristles, mounted on twisted G.I. wire head 150 x 15 mm, overall length 900 mm

CHE-676
TEST TUBE BRUSH
Hard nylon bristles mounted on twisted G.I. wire head 90 x 45 mm, overall length 250 mm.

CHE-677
FLASK BRUSH
Hard nylon bristles mounted on twisted G.I. wire head 130 x 50 mm overall length 360 mm.

BURETTES

CHE-678
BURETTE POLYPROPYLENE
Unbreakable, transparent burette, fitted with P.T.F.E. stopcock.

	Capacity, ml	Subdivision, ml
CHE-678.1	25	0.1
CHE-678.2	50	0.1

CHE-679
BURETTE NEUTRAL GLASS, GLASS JET
Neutral glass, with pinch clip, rubber tubing and glass jet.

	Capacity, ml	Subdivision, ml
CHE-679.1	25	0.1
CHE-679.2	50	0.1
CHE-679.3	100	0.2

CHE-680
BURETTE NEUTRAL GLASS, GLASS STOP COCK
Neutral glass, with straight bore leak proof glass stopcock.

	Capacity, ml	Subdivision, ml
CHE-680.1	25	0.1
CHE-680.2	50	0.1
CHE-680.3	100	0.2

CHE-681
BURETTE BOROSILICATE GLASS CLASS "B"
Borosilicate glass, with straight bore leak proof stopcock. Class "B"

	Capacity, ml
CHE-681.1	10 X 0.05
CHE-681.2	25 X 0.1
CHE-681.3	50 X 0.1
CHE-681.4	100 X 0.2

CHE-682
BURETTE BOROSILICATE GLASS CLASS "A"
Borosilicate glass, with straight bore leak proof stopcock. Class "A"

	Capacity, ml
CHE-682.1	10 X 0.05
CHE-682.2	25 X 0.1



CHE-669



CHE-672

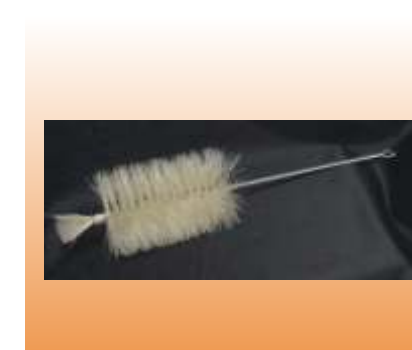

CHE-674



CHE-676



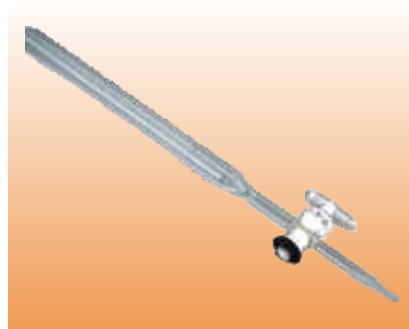

CHE-681

CHE-682.3	50 X 0.1	
CHE-682.4	100 X 0.2	
CHE-683		
BURETTE BOROSILICATE GLASS, P.T.F.E. STOPCOCK		
Borosilicate glass with P.T.F.E. stopcock, Class 'B' accuracy.		
	Capacity, ml	Subdivision, ml
CHE-683.1	10	0.05
CHE-683.2	25	0.1
CHE-683.3	50	0.1
CHE-683.4	100	0.2

CHE-684		
BURETTE, ROTAFLOW		
Borosilicate glass with P.T.F.E. stopcock, class 'B' accuracy.		
	Capacity, ml	Subdivision, ml
CHE-684.1	10	0.05
CHE-684.2	25	0.1
CHE-684.3	50	0.1
CHE-684.4	100	0.2

CHE-685		
BURETTE CLAMP		
Die pressed burette clamp of plated steel, Holds burette in vertical position, jaws having V grooves, with boss to accommodate rods upto 16 mm dia.		
CHE-685.1	for one burette	
CHE-685.2	for two burette.	

CHE-686		
BURETTE CLAMP		
High density polythene body, non-corrosive, unbreakable, easy to fit burette graduation can be seen clearly along its entire length.		
CHE-686.1	for one burette	
CHE-686.2	for two burette.	

CHE-687		
BURETTE STAND		
Cork lined wooden clamp with plastic screw, base with four rubber feet, rod fitted with socket with thread which fits into the base, polished.		
CHE-687.1	for one burette	
CHE-687.2	for two burette.	

CHE-688		
BURETTE AND FUNNEL STAND		
Same as CHE-688, but can hold one burette and one funnel.		

BURNERS

CHE-689		
BUNSEN BURNER		
Nickel plated burner tube 100 x 12 mm, with adjustable screwed air regulator, rifled connector, mounted on a stove enamelled, pressed steel wide base of 80 mm dia. Overall height 125 mm. With one spare jet.		

CHE-690		
BUNSEN BURNER		
Nickel plated burner tube 100 x 12 mm with stabilizer top rotatable air regulator, produces smooth, well regulated and hot flame. Die pressed steel stove enamelled base of 80 mm dia for exceptional stability. Overall height 125 mm.		

CHE-691		
BUNSEN BURNER, WITH STOPCOCK		
As CHE-691, but fitted with a stopcock in the inlet tube control flow of gas.		

CHE-692		
MEKER BURNER		
Nickel plated burner tube with perforated plate of 25 mm dia at top, which provides flame stability and ensures high and evenly distributed temperature. With rotatable air regulator around the jet. Heavy wide die pressed metal base of 80 mm dia. With rifled gas inlet, overall height 150 mm.		

CHE-693		
TECLU BURNER		
Suitable for requirement of very hot flame. Heavy gauge nickel plated brass tube of 12 mm dia. with air regulating disc, jet inlet tube and gas control needle valve, on heavy die pressed metal base.		

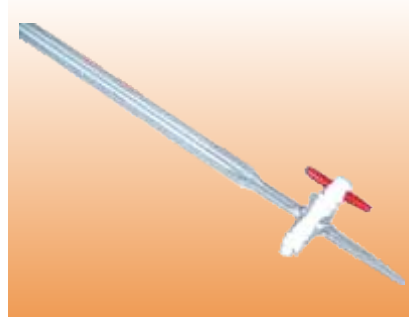

CHE-682



CHE-685

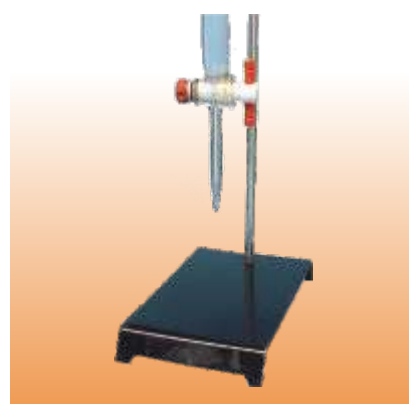

CHE-691



CHE-694		
BURNER, GLASS, METHYLATED SPIRIT		
Glass, with cap, wick and metal wick holder.		
CHE-694.1	60 ml	
CHE-694.2	125 ml	

CHE-695		
BURNER, METAL, METHYLATED SPIRIT		
Metal, complete with wick, wick holder and cap.		
CHE-695.1	aluminium	60 ml
CHE-695.2	aluminium	125 ml
CHE-695.3	brass	60 ml
CHE-695.4	brass	125 ml

CENTRIFUGES

CHE-696		
CENTRIFUGE HAND		
Hand Operated, removable crank handle and head for bench mounting supplied complete with aluminium buckets for 15 ml glass tubes.		
CHE-696.1	Cast metal body	for 2 tubes
CHE-696.2	Cast metal body	for 4 tubes
CHE-696.3	Moulded ABS body	for 2 tubes
CHE-696.4	Moulded ABS body	for 4 tubes

CHE-697		
CENTRIFUGE, ELECTRICAL		
Electrically Operated, Safe, with 5 speed control switch. Max speed 3500 rpm, easy to use, has a heavy spun aluminium guard bowl and cover which completely enclose the head. Motor and controls are housed below the bowl for safety. The internal and external surfaces are finished with a smooth easily cleaned stove enamelled paint. Motor is supported on flexible rubber mounting which makes critical balancing of the tubes unnecessary. Complete with 4 x 15 ml swing out head with 4 metal buckets and 4 glass tubes. Workable on 220 V, 50 Hz.		

CHE-698		
CENTRIFUGE, LABORATORY		
Completely Enclosed Model, Adjustable speed max, 5000 rpm Head and motor completely enclosed. Suitable for doctors, pathological laboratories and other users. A wide range of rotors and other accessories make this centrifuge ideal for most applications. The features include solid state speed controller, indicator lamp, see through acrylic lid, Supplied without head. Workable on 220 V, 50 Hz.		

CHE-699		
CENTRIFUGE TUBE GLASS		
Glass, capacity 15 ml.		
CHE-699.1	Conical bottom	
CHE-699.2	Round bottom	

CORK BORER

CHE-700		
CORK BORER		
Brass, Chrome plated, different size tubes each with cutting edge at bottom and handle at top, with cleaning rod.		
CHE-700.1	Set of 6 borers, 4-12 mm	
CHE-700.2	Set of 12 borers, 4-19 mm.	

CHE-701		
CORK BORER SHARPENER		
Plated metal cone with hinged cutter blade set in slot, with wooden handle.		

CHE-702		
CORK PRESS		
Mounted on polished wooden base, Cast iron, for softening corks. To accommodate cork upto 32 mm dia.		

CHE-703		
CLIP, MOHR		
Nickel Plated, round edges, for use with tubes upto 11 mm outer diameter.		



CHE-689



CHE-696



CHE-700



CHE-702





CHE-699

CHE-704
CLIP, HOFFMAN
Brass Nickel Plated, Screwed hinged side bar, for use with tubes upto 20 mm outer diameter.

CHE-705
COMBUSTION BOAT, PORCELAIN
With handle 80 x 12 x 10 mm

CONDENSERS

CHE-706
CONDENSER, LIEBIG BOROSILICATE GLASS
Borosilicate glass, inner tube fused into outer jacket.

	Effective length, mm
CHE-706.1	200
CHE-706.2	250
CHE-706.3	300
CHE-706.4	450
CHE-706.5	500



CHE-700

CHE-707
CONDENSER, GRAHAM, SPIRAL FORM
Borosilicate glass.

	Effective length, mm
CHE-707.1	200
CHE-707.2	300
CHE-707.3	400
CHE-707.4	500

CHE-708
CONDENSER, THORPE
Borosilicate glass, inland Revenue pattern, effective length 200 mm.

CHE-709
CONDENSER, DAVIES, DOUBLE SURFACE
Borosilicate glass, effective length 200 mm.

CRUCIBLES

CHE-710
CRUCIBLE GOOCH PORCELAIN
Porcelain, tall form, fixed perforated bottom, all glazed except outer bottom.

	Dia, mm	Ht, mm	Capacity, ml
CHE-710.1	32	26	15
CHE-710.2	37	38	20
CHE-710.3	40	45	30
CHE-710.4	53	49	50



CHE-706

CHE-711
CRUCIBLE, SQUAT PORCELAIN
Porcelain, glazed inside and outside complete with lid.

	Dia, mm	Ht, mm	Capacity, ml
CHE-711.1	41	20	10
CHE-711.2	42	25	15
CHE-711.3	60	37	50
CHE-711.4	92	52	150

CHE-712
CRUCIBLE, TALL FORM
Porcelain, glazed inside and outside, complete with lid.

	Dia, mm	Ht, mm	Capacity, ml
CHE-712.1	31	25	10
CHE-712.2	37	38	20
CHE-712.3	45	38	30
CHE-712.4	53	49	50
CHE-712.5	75	61	100



CHE-707

CHE-713
CRUCIBLE, MICRO, PORCELAIN
Squat form glazed with lid

	Dia, mm	Ht, mm	Capacity, ml
CHE-713.1	18	12	1
CHE-713.2	23	15	3
CHE-713.3	30	18	5
CHE-713.4	30	20	6
CHE-713.5	33	20	8

CHE-714
CRUCIBLE, SILICA, QUARTZ, SQUAT
Translucent, complete with lid.

	Dia, mm	Ht, mm	Capacity, ml
CHE-714.1	19	29	5
CHE-714.2	19	38	10
CHE-714.3	25	41	15
CHE-714.4	28	47	25
CHE-714.5	37	57	50

CHE-715
CRUCIBLE, PURE NICKEL
Polished, complete with lid.

	Capacity, ml.
CHE-715.1	15
CHE-715.2	25
CHE-715.3	50

CYLINDERS

CHE-716
CYLINDER, MEASURING GLASS
Glass, with spout, graduated.

	Capacity, ml.
CHE-716.1	10
CHE-716.2	25
CHE-716.3	50
CHE-716.4	100
CHE-716.5	250
CHE-716.6	500
CHE-716.7	1000
CHE-716.8	2000

CHE-717
CYLINDER, MEASURING BOROSILICATE GLASS
Borosilicate glass with spout and glass base.

	Capacity, ml.
CHE-717.1	10
CHE-717.2	25
CHE-717.3	50
CHE-717.4	100
CHE-717.5	250
CHE-717.6	500
CHE-717.7	1000
CHE-717.8	2000

CHE-718
CYLINDER, MEASURING BOROSILICATE GLASS WITH PLASTIC BASE
Borosilicate, glass, with spout class B with detachable plastic base.

	Capacity, ml	Subdivision,
CHE-718.1	10	0.2
CHE-718.2	25	0.5
CHE-718.3	50	1
CHE-718.4	100	1

CHE-719
CYLINDER, MEASURING POLYTHENE
With spout, polythene

	Capacity, ml
CHE-719.1	5
CHE-719.2	10
CHE-719.3	25
CHE-719.4	50
CHE-719.5	100
CHE-719.6	250
CHE-719.7	500



CHE-710



CHE-713



CHE-715



CHE-716





CHE-718

CHE-719.8	1000
CHE-719.9	2000
CHE-720	
CYLINDER, MEASURING POLYTHENE	
With spout, TPX, transparent, plastic, rigid.	
	Capacity, ml
CHE-720.1	10
CHE-720.2	25
CHE-720.3	50
CHE-720.4	100
CHE-720.5	250
CHE-720.6	500
CHE-720.7	1000



CHE-719

CHE-721
DEFLAGRATING SPOON
Die pressed steel spoon, 20 mm dia welded with rod. Complete with cover of 90 mm dia having cork in centre for holding the rod.

CHE-722
COMBUSTION SPOON, NUFFLED.
Made of stainless steel wire, 200 mm length, for use in test tube 150 x 25 mm.

DESSICATOR

CHE-723
DESSICATOR GLASS
Glass, with ground glass cover having knob at top.

	Dia, mm.
CHE-723.1	100
CHE-723.2	125
CHE-723.3	150
CHE-723.4	200
CHE-723.5	250

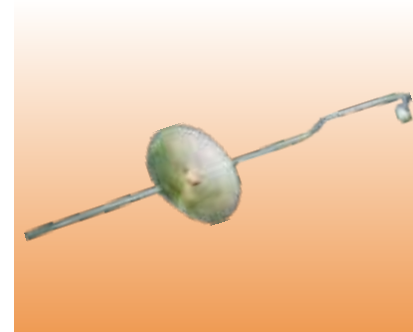

CHE-722

CHE-724
DESSICATOR, VACCUUM, GLASS
Glass, ground glass cover fitted with stopcock.

	Dia, mm.
CHE-724.1	150
CHE-724.2	250

CHE-725
DESSICATOR BOROSILICATE GLASS
Borosilicate glass, with cover.

	Dia, mm.
CHE-725.1	110
CHE-725.2	160
CHE-725.3	200
CHE-725.4	250



CHE-723

CHE-726
DESSICATOR, VACUUM, BOROSILICATE GLASS
Borosilicate glass, 160 mm dia.

CHE-727
DESSICATOR VACCUUM POLYPROPYLENE
Autoclavable Top dome moulded in rigid and transparent. Stopcock is fitted with a PTFE plug. 150 mm

CHE-728
DESSICATOR PLAIN POLYPROPYLENE
Autoclavable Top dome moulded in rigid and transparent. 150 mm

DISHES

CHE-729
DISH, CRYSTALLIZING
Borosilicate glass,

	O.D., mm.	Ht., mm.
CHE-729.1	100	50
CHE-729.2	150	75
CHE-729.3	190	100



CHE-724

CHE-730
PETRI DISH
Glass fused edges complete with cover.

	Dia, mm.
CHE-730.1	50
CHE-730.2	75
CHE-730.3	90
CHE-730.4	100
CHE-730.5	125



CHE-727

CHE-731
PETRI DISH, BOROSILICATE GLASS
Borosilicate glass, withstands repeated sterilization, complete with cover.

	Dia., mm.	Ht., mm.
CHE-731.1	50	17
CHE-731.2	80	17
CHE-731.3	100	17
CHE-731.4	150	20
CHE-731.5	200	20

CHE-732
PETRI DISH, WITH COVER
Disposable, clear polystyrene, supplied in sterilized pack.

	Dia., mm.
CHE-732.1	55
CHE-732.2	90

CHE-733
STERILISING BOX FOR PETRI DISHES
For holding 12 pairs dishes upto 100 mm dia for autoclaving. Cylindrical can with lid and internal removable carrier. Made of stainless steel.

DISTILLATION APPARATUS

CHE-734
DISTILLATION APPARATUS
With ground glass standard interchangeable jointed borosilicate glass. Comprises round bottom flask with 24/29 socket, still head with 24/29 and 19/26 cones and 19/26 socket, condenser with 19/26 socket and cone, receiver.

CHE-734.1	Flask capacity 1 litre, condenser 200 mm
CHE-734.2	Flask capacity 2 litres condenser 400 mm
CHE-734.3	Flask capacity 3 litres condenser 450 mm



CHE-729

CHE-735
DISTILLATION APPARATUS
With ground glass standard interchangeable jointed borosilicate glass. Comprises round bottom flask with 24/29 socket, still head with 24/29 and 19/26 cones and 19/26 socket, condenser with 19/26 socket and cone, receiver with 19/26 socket, separating funnel 100 ml with 19/26.

CHE-735.1	Flask capacity 1 litre, condenser 200 mm
CHE-735.2	Flask capacity 2 litres condenser 400 mm
CHE-735.3	Flask capacity 3 litres condenser 450 mm

CHE-736
DISTILLATION APPARATUS, VERTICAL TYPE, SINGLE STAGE
Borosilicate glass, consists of double walled condenser with standard interchangeable ground joints.

	Capacity, litre
CHE-736.1	1
CHE-736.2	2
CHE-736.3	3
CHE-736.4	4



CHE-731





CHE-732



CHE-734

CHE-736.5 5

CHE-737

DISTILLATION APPARATUS, VERTICAL TYPE, DOUBLE STAGE

Borosilicate glass consists of double walled condenser with standard interchangeable ground joints.

	Capacity, litre
CHE-737.1	1
CHE-737.2	2
CHE-737.3	3
CHE-737.4	4
CHE-737.5	5

CHE-738

DISTILLATION COLUMN, FRACTIONATING, YOUNG'S

Borosilicate glass, pear shaped bulbs, with side tube.

	No. of tubes
CHE-738.1	8
CHE-738.2	12

CHE-739

DISTILLATION COLUMN, FRACTIONATING

Borosilicate glass, rod and disc type with side tube.

	No. of discs
CHE-739.1	15
CHE-739.2	20

CHE-740

ELECTROLYSIS CELL

Open ended glass tube 75 x 25 mm fitted with 2 carbon electrodes through a rubber cork, separated by a plastic sheet, complete with two collecting tubes of size 75 x 25 mm.

CHE-741

VOLTAMETER, COPPER

Two copper plates, size 120 x 50 mm, each fitted with a terminal on the top. Complete with glass jar 150 x 100 mm.

CHE-742

HOFFMAN VOLTAMETER

Hoffman voltmeter for water analysis with two platinum and two poles supplies with plastic base, dimensions approx 175 x 250 mm, with suitable wire connection, 500 m long and 4 spare electrodes for each type with power supply.

CHE-742.1	Borosilicate glass
CHE-742.2	Neutral glass

CHE-743

PLATINIUM ELECTRODES

Platinum wire or foil fused into glass rod with internal lead, with rubber stopper and glass protection tube per pair.

CHE-744

FILTER PAPER

Suitable for quantitative work.

	Dia. mm
CHE-744.1	90
CHE-744.2	110
CHE-744.3	125
CHE-744.4	150
CHE-744.5	185
CHE-744.6	215
CHE-744.7	240

CHE-745

FILTER PAPER

Suitable for school use.

	Dia. mm
CHE-745.1	90

CHE-745.2	110
CHE-745.3	125
CHE-745.4	150
CHE-745.5	185
CHE-745.6	215
CHE-745.7	240

CHE-746

FILTER PUMP

Glass, rifled inlet and outlet tubes length 200 mm.

CHE-747

FILTER PUMP

Chrome plated brass, with water inlet nozzle and vacuum nozzle.

CHE-748

FILTER PUMP

Polypropylene, with non-return valve and arm for removable hose connection. Suitable for use with corrosive filtrates.

FLAME TEST

CHE-749

PLATINIUM WIRE

Platinum wire fused into glass rod, protected in a glass tube.

CHE-750

COBALT GLASS

Dark blue glass, size 75 x 25 mm.

FLASKS

CHE-751

FLASK, FLAT BOTTOM

Capacity, ml	Glass	Borosilicate glass
100	CHE-751.1	CHE-751.5
250	CHE-751.2	CHE-751.6
500	CHE-751.3	CHE-751.7
1000	CHE-751.4	CHE-751.8

CHE-752

FLASK, ROUND BOTTOM

Capacity, ml	Glass	Borosilicate glass
100	CHE-752.1	CHE-752.5
250	CHE-752.2	CHE-752.6
500	CHE-752.3	CHE-752.7
1000	CHE-752.4	CHE-752.8

CHE-753

FLASK, CONICAL (ERLENMEYER)

Capacity, ml	Glass	Borosilicate glass
50	CHE-753.1	CHE-753.6
100	CHE-753.2	CHE-753.7
250	CHE-753.3	CHE-753.8
500	CHE-753.4	CHE-753.9
1000	CHE-753.5	CHE-753.10

CHE-754

FLASK, DISTILLATION, WITH SIDE TUBE

	Capacity, ml.
CHE-754.1	100
CHE-754.2	250
CHE-754.3	500
CHE-754.4	1000

CHE-755

FLASK, FILTER

With tubule at side

Capacity, ml	Glass	Borosilicate glass
100	CHE-755.1	CHE-755.5
250	CHE-755.2	CHE-755.6



CHE-741



CHE-743



CHE-744

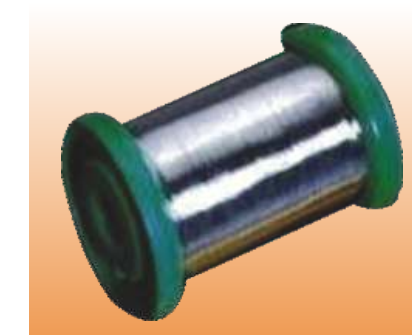

CHE-749





CHE-751

500	CHE-755.3	CHE-755.7
1000	CHE-755.4	CHE-755.8

CHE-756
FLASK SUPPORT, POLYPROPYLENE
For round bottom flasks upto 10 litres, autoclavable.

CHE-757
FLASK, VOLUMETRIC, ONE MARK
Glass with glass stopper.

	Capacity, ml.
CHE-757.1	50
CHE-757.2	100
CHE-757.3	250
CHE-757.4	500
CHE-757.5	1000

CHE-758
FLASK, VOLUMETRIC, ONE MARK
Borosilicate glass, with interchangeable glass stopper.

Capacity, ml	Class "B"
50	CHE-758.1
100	CHE-758.2
250	CHE-758.3
500	CHE-758.4
1000	CHE-758.5

CHE-759
FLASK, VOLUMETRIC, ONE MARK
Borosilicate glass with polypropylene stopper.

Capacity, ml	Class "B"
50	CHE-759.1
100	CHE-759.2
250	CHE-759.3
500	CHE-759.4
1000	CHE-759.5
2000	CHE-759.6

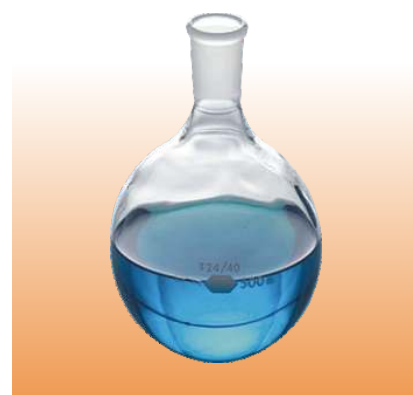

CHE-752



CHE-753



CHE-754

FUNNELS

CHE-760
FILTER FUNNEL
Plain, long stem

Dia, mm	Glass	Borosilicate glass
50	CHE-760.1	CHE-760.7
62	CHE-760.2	CHE-760.8
75	CHE-760.3	CHE-760.9
100	CHE-760.4	CHE-760.10
150	CHE-760.5	
200	CHE-760.6	

CHE-761
FILTER FUNNEL, POLYTHENE

	Dia, mm
CHE-761.1	50
CHE-761.2	75
CHE-761.3	100
CHE-761.4	125
CHE-761.5	150
CHE-761.6	200

CHE-762
DROPPING FUNNEL, CYLINDRICAL
Open top, with stopcock.

Capacity ml.	Neutral Glass	Borosilicate glass
25	CHE-762.1	CHE-762.4
50	CHE-762.2	CHE-762.5
100	CHE-762.3	CHE-762.6

CHE-763
SEPARATING FUNNEL, CYLINDRICAL

With stopcock, and glass stopper.

Capacity, ml	Neutral Glass	Borosilicate glass
25	CHE-763.1	CHE-763.5
50	CHE-763.2	CHE-763.6
100	CHE-763.3	CHE-763.7
250	CHE-763.4	CHE-763.8

CHE-764
SEPARATING FUNNEL, CYLINDRICAL
Borosilicate glass, with rotaflow stopcock and 14/23 ground glass socket on top.

	Capacity, ml
CHE-764.1	50
CHE-764.2	100

CHE-765
SEPARATING FUNNEL, PEAR SHAPED

Capacity, ml	Neutral Glass	Borosilicate glass
50	CHE-765.1	CHE-765.5
100	CHE-765.2	CHE-765.6
250	CHE-765.3	CHE-765.7
500	CHE-765.4	CHE-765.8

CHE-766
BUCHNER FUNNEL PORCELAIN
Porcelain, straight sides, integral perforated plated, glazed inside and outside Size 100 mm

CHE-767
BUCHNER FUNNEL POLYPROPYLENE
Moulded in Polypropylene, light weight, autoclavable Size 110 mm

CHE-768
THISTLE FUNNEL
Neutral glass, stout wall.

	Length, mm
CHE-768.1	200
CHE-768.2	250
CHE-768.3	300

CHE-769
THISTLE FUNNEL, SHORT STEM
Neutral glass, for filling barometer tubes, burette etc.

CHE-770
THISTLE FUNNEL, POLYTHENE
Unbreakable polythene top with 6 mm glass tube.

CHE-771
THISTLE FUNNEL, SAFETY
With bend and two safety bulbs, length of stem 300 mm.

	Neutral glass	Borosilicate glass
CHE-771.1		
CHE-771.2		

CHE-772
FUNNEL STAND
Cork lined wood clamp with plastic screw, base with four feet, rod fitted with plastic socket one end having threads which fit into the base.

CHE-772.1	For one funnel
CHE-772.2	For two funnels

CHE-773
KIPP'S APPARATUS BOROSILICATE GLASS (GAS GENERATOR)
Glass with outlet near bottom, safety funnel, stopcock and rubber stopper.

Capacity ml.	Glass	Borosilicate glass
250	CHE-773.1	CHE-773.4
500	CHE-773.2	CHE-773.5
1000	CHE-773.3	

CHE-774
KIPP'S APPARATUS POLYTHENE (GAS GENERATOR)
High density polythene unbreakable, leakproof, detachable for easy cleaning.

	Capacity, ml
CHE-774.1	250
CHE-774.2	500
CHE-774.3	1000



CHE-759



CHE-765



CHE-767



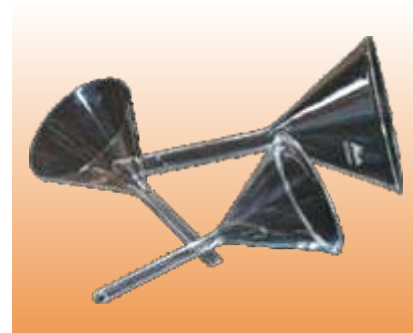

CHE-768



CHE-772



CHE-774



CHE-775, 776

CHE-775

GAS JAR

Glass with foot and ground flange.

	Dia, mm	Height, mm
CHE-775.1	50	150
CHE-775.2	50	200
CHE-775.3	75	250
CHE-775.4	75	300

CHE-776

GAS JAR COVER

Ground glass, circular, dia 75 mm.

CHE-777

GAS WASHING BOTTLE

Flat bottom flask with stopper and two glass tubes.

	Capacity ml.
CHE-777.1	250
CHE-777.2	500
CHE-777.3	1000

CHE-778

GAS WASHING BOTTLE, DRESCHEL'S

Borosilicate glass, inlet and outlet tubes in a stopper which fits the bottle having interchangeable 19/26 ground glass joint.

	Capacity ml.
CHE-778.1	125
CHE-778.2	250

CHE-779

GAUZE, IRON

With folded edges.

Size, mm	Asbestos Centre	Ceramic Centre
125 x 125	CHE-779.1	CHE-779.3
150 x 150	CHE-779.2	CHE-779.4

CHE-780

HEATING MANTLE

Glass yarn heating net in one piece aluminium body, with mineral wool lagging, for 220-240 V AC to work upto 3500.

Capacity, ml	Rating, W	With off/on switch	With energy regulator
50-250	80	CHE-780.1	CHE-780.4
250-500	200	CHE-780.2	CHE-780.5
1000	300	CHE-780.3	CHE-780.6

CHE-781

HEATING MANTLE, MULTI-SIZE

One mantle can be used for different sizes flasks.

Capacity, ml	Rating, W	With off/on switch	With energy regulator
50-250	200	CHE-781.1	CHE-781.4
250-500	200	CHE-781.2	CHE-781.5
250-1000	300	CHE-781.3	CHE-781.6

CHE-782

SOXHLET EXTRACTION HEATING UNIT

Unit comprises a compact box section of mild steel housing. Heating mantles consist of coiled element supported by glass yarn net. These flexible units ensure close contact with flask surface and even distribution of heat. The housing has two vertical and two horizontal rods with clamps to fix glass apparatus. Each heating mantle is provided with an energy regulator and indicator lamp. Without glass parts.

CHE-782.1	Unit of three mantles, 375 watt
CHE-782.2	Unit of six mantles, 750 watt

CHE-783

KJELDAHL DISTILLATION UNIT

Useful for distillation for 300 and 500 ml flasks, provided with tubular stand and brass condenser rack. Each heating mantle is provided with an energy regulator and indicator lamp, with six heating mantles, without glass parts.

CHE-784

KJELDAHL DIGESTION UNIT

Useful for estimation nitrogen contents of substances by digestion for 300 and 500 ml flask. Provided with lead fume duct, mild steel stand and pair of hanger. Each heating mantle has an energy regulator and indicator lamp, without glass parts.

CHE-784.1 unit with six heating mantles.

CHE-785

HOT PLATE

Laboratory round top dia 20 cm approx 1.5 kW heats, upto 350. Provided with indicator lamp and 3-position rotary switch. For 220-240 V.A.C.

CHE-786

HOT PLATE

As CHE-786, but with energy regulator to vary temperature continuously.

CHE-787

HOT PLATE, RECTANGULAR

For temperature upto 400 C top size 25 x 30 x 15 cm, 1.2 kW.

CHE-787.1	With tumbler switch.
CHE-787.2	With energy regulator for continuous variation of temperature.
CHE-787.3	With thermostat.

CHE-788

INCUBATOR, UNIVERSAL

Very sturdy elegantly painted Double walled, inner chamber made of thick anodized aluminium or stainless steel and outer of mild steel. The gap of 75 mm between two walls is filled with glass wool for heat insulation. The door has double viewing to permit observation without opening. Heating elements are placed in ribs at the bottom and at sides. Built in L-shape horizontal thermometer 0 to 110° for uniform heating. Temperature is controlled by a precision thermostat from 5° C above room temperature to 70° with sensitivity of ±1° C Complete with 2 indicator lamps adjustable perforated shelves. Having arrangement to fit an automatic timer. Works on 220-240, 50 Hz. Supplied complete with 1.5 metre of 3-core cable.

Size inner chamber, mm	No. of shelves	Aluminium	Stainless steel
300 X 300 X 300	2	CHE-788.1	CHE-788.6
450 X 450 X 450	2	CHE-788.2	CHE-788.7
600 X 600 X 600	2	CHE-788.3	CHE-788.8
600 X 600 X 450	3	CHE-788.4	CHE-788.9
600 X 900 X 600	3	CHE-788.5	CHE-788.10

CHE-789

OPTIONAL ACCESSORIES

Can be fitted, in any of the above sizes.

CHE-789.1	Timer
CHE-789.2	Circulatory Fan
CHE-789.3	Electronic digital temperature indicator

JARS

CHE-790

SPECIMEN JAR

Round, with ground flange, knobbed stopper.

	Ht. x dia, mm
CHE-790.1	150 X 50
CHE-790.2	200 X 50
CHE-790.3	250 X 50
CHE-790.4	200 X 75
CHE-790.5	250 X 75

CHE-791

SPECIMEN JAR

Rectangular with cover but without stopper.

	Ht. x Length x Width, mm
CHE-791.1	50 X 50 X 30



CHE-780

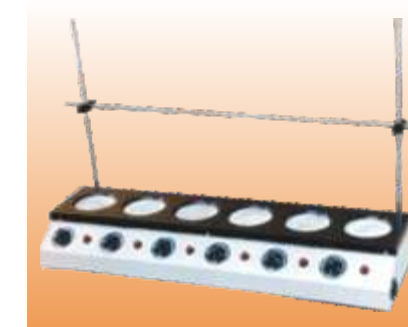

CHE-782

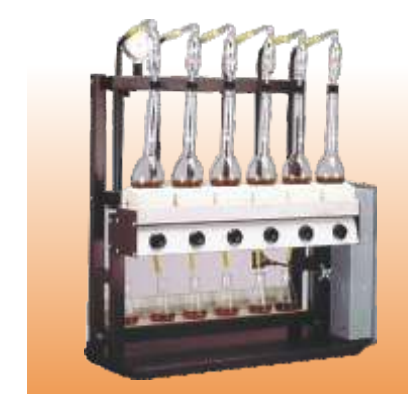

CHE-784



CHE-787





CHE-788

CHE-791.2	100 X 50 X 60
CHE-791.3	150 X 100 X 50
CHE-791.4	150 X 120 X 90
CHE-791.5	200 X 100 X 50

LABORATORY FITTINGS

CHE-792

WATER TAP, SWAN NECK

Outlet tube made of Brass Inlet tail is threaded 1/2 in. BSP. The outlet tube is coupled to the tap standard by means of a sleeve nut allowing the neck to swivel or top be locked in any desired direction. Leakproof operation, designed for pressures upto 80 p.s.i. finished in hard chrome plating.

CHE-792.1	Water tap, single
CHE-792.2	Water tap two way

CHE-793

GAS TAPS

Sturdy, rigid and leakproof. Each piece is tested for pressure. Lever handle is spring loaded and has locking arrangement to ensure that rotation does not go beyond 90° standard nozzles have 1 mm bore, inlet 1/4 in BSP. flange dia 54 mm with three holes to screw on bench or any other surface. Designed to operate pressure upto 2 p.s.i suitable for coal gas, natural gas or bottled L.P.G. supplied complete with adaptor.

CHE-793.1	One way gas tap
CHE-793.2	Two way gas tap
CHE-793.3	Three way gas tap
CHE-793.4	Four way gas tap

MEASURING INSTRUMENTS

CHE-794

VERNIER CALPIER WHEEL DRIVEN

Steel, Chromium plated, one side graduated in inches (5") & the other in cms. (12.5) wheel drive for inside, outside and depth measurement with lock in card board cover.



CHE-790

CHE-795

VERNIER CALPIER PLASTIC

Made of Plastic, one side graduated in inches (6") & the other in mm (150) . for inside, outside and depth measurement

CHE-796

VERNIER CALIPERS IME TYPE

Made of chromium steel for inside, outside and depth measurements with crossed jaws designed for high precision work. One side graduate in inches and other in cm. Thumb adjusting sliding lock, chrome polished packed in a case.

	Size
CHE-796.1	6" - 15 cm.
CHE-796.2	8" - 20 cm.
CHE-796.3	10" - 25 cm.
CHE-796.4	12" - 30 cm.



CHE-792

CHE-797

VERNIER DEMONSTRATION MODEL

Straight wooden 30 cm. long vernier 1/100 x cm. polished.

CHE-798

CALIPERS GAUGE BRASS

Made of Complete Brass one side marked in inches and other in mm. Available in three sizes also called pocket caliper packed in a poly bag

CHE-798.1	2" - 50 mm
CHE-798.2	3" - 75 mm
CHE-798.3	4" - 100 mm

CHE-799

MICROMETER SCREW GAUGE

Frame and Sleeve made of brass, steel rod hardened and grounded screw, thimble with ratchet for high precision work packed in cardboard cover.

CHE-799.1	0-10 mm
CHE-799.2	0-15 mm
CHE-799.3	0-20 mm

CHE-800



CHE-793

**MICROMETER SCREW GAUGE**

Made of brass, steel rod hardened and grounded screw thimble with ratchet for high precision work sand blast finish very superior quality packed in a plastic case.

CHE-800.1	25x1/100mm.
CHE-800.2	25 x 1/200 mm
CHE-800.3	1 inch

CHE-801

MICROMETER SCREW GAUGE

Die cast Body Brass Sleeve, steel rod hardened and grounded screw thimble with ratchet for high precision work, elegantly finished with duco paint, most superior quality. Packed in a storage case

	Size
CHE-801.1	1-2" / 25-50 mm
CHE-801.2	2-3" / 50-75 mm
CHE-801.3	3-4" / 75-100 mm

CHE-802

MICROMETER INSIDE

Made of brass, for high precision work, elegantly sand blast chrome finished, most superior quality. Available in three sizes packed in a storage wooden case

	Size
CHE-802.1	2-6" / 50-150 mm
CHE-802.2	2-8" / 50-200 mm
CHE-802.3	2-12" / 50-300 mm

CHE-803

MICROMETER SCREW GAUGE DELUXE

Die cast heavy body with Brass Sleeve, steel rod hardened and grounded screw thimble with ratchet for high precision work, with locking facility elegantly finished with duco paint, very superior quality packed in a wooden case.

CHE-803.1	25 mm
CHE-803.2	1 inch.

CHE-804

MICROMETRICAL HEAD

Made of brass, steel rod hardened and grounded for high precision work very smooth operation, elegantly finished, most superior quality. Available in four sizes.

CHE-804.1	10 mm
CHE-804.2	15 mm
CHE-804.3	20 mm
CHE-804.4	25 mm.
CHE-804.5	50 mm.

CHE-805

METRE RULE

Made of wood, 25 mm wide, double scale in mms, figured every cms. The scale on the two edges read in opposite directions.

CHE-805.1	1 metre
CHE-805.2	1/2 metre

CHE-806

METRE RULE

Made of wood, 25 mm wide, double scale in mms, figured every cm both scales reads from bottom to top

CHE-806.1	1 metre
CHE-806.2	1/2 metre

MELTING POINT APPARATUS

CHE-807

MELTING POINT APPARATUS

Consist of an aluminium block which accepts three capillary tubes and thermometer. The block is heated by two heating elements which are provided with a built in energy regulator, for uniform and shadowless illumination a lamp is provided. works on 220 V 50 Hz.

CHE-808

COOLING PLUG

Water cooled metal plug which can be inserted in thermometer pocket for rapid cooling of heating block to reduce cooling time.

CHE-809



CHE-794



CHE-796



CHE-798

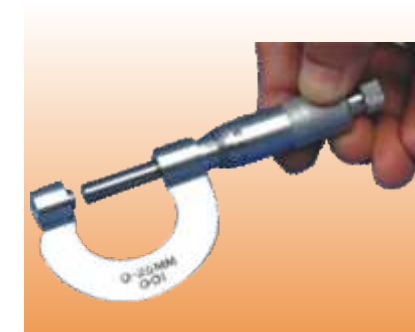

CHE-799





CHE-805



CHE-807

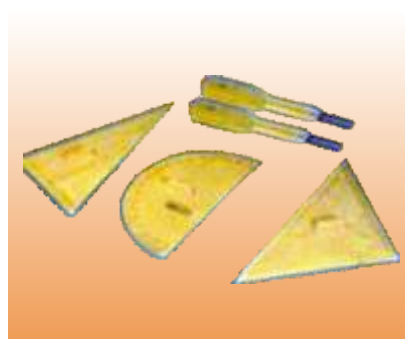

CHE-810



CHE-812

MELTING POINT TUBES

Thin walled capillary tubes, 100 x 1k. 8 mm approx. pack of 100 tubes.

GEOMETRICAL MODELS

CHE-810

GEOMETRICAL MODELS AND FIGURES
Made of hard wood, set of 16, in box.

CHE-811

GEOMETRICAL MODELS

Set of plane and solid geometric shapes. Plane shapes include triangles, figures with four, five, six, seven, eight, nine and ten sides, circle, semi-circle and quadrant. The solid shapes include cylinder, sphere, cube, tetrahedron, pyramid, cone, prism. Cube size 30 mm, cylinder height 50 mm.

CHE-812

ATOMIC MODEL SET

With plastic balls in various sizes and colours and link lugs in box.

CHE-812.1 Set of 60 balls CHE-812.2 Set of 120 balls

CHE-813

PERIODIC CHART OF ATOMS

Multi coloured showing solids liquids, gases in separate distinctive colours with symbols and names, density atomic radii melting points, boiling points, atomic numbers atomic weights electronic structure, crystal structure, valency, ionization potential, electro negativity, etc. Information about 105 elements is given. Size 140 x 100 cm. mounted with rollers.

MORTAR AND PESTLE

CHE-814

MORTAR AND PESTLE GLASS

Glass, with spout.

	Dia, mm
CHE-814.1	60
CHE-814.2	90
CHE-814.3	100
CHE-814.4	150

CHE-815

MORTAR AND PESTLE PORCELAIN

Porcelain, with spout, glazed outside, unglazed inside.

	Inside Dia, mm	Capacity, ml
CHE-815.1	60	60
CHE-815.2	75	100
CHE-815.3	100	275
CHE-815.4	150	900
CHE-815.5	200	2000

ORGANIC CHEMISTRY**LABORATORY GLASSWARE WITH INTERCHANGEABLE STANDARD JOINTS**

Glassware in Borosilicate Glass The joints are ground to international specification and are ideal for inter connecting laboratory apparatus. Only a few items sizes are given hereunder. We can however, fabricate and supply many other items with various standard joints eg. adaptors, receivers, condensers, etc. We can also supply various sets and assemblies employing standard joints.

CHE-816

CONDENSER AIR

Borosilicate glass.

	Effective Length, mm	Socket Cone
CHE-816.1	100	10/1910/19
CHE-816.2	200	14/2314/23

CHE-817

CONDENSER LIEBIG

Borosilicate glass.

	Effective Length, mm	Socket	Cone
CHE-817.1	65	10/19	10/13

CHE-817.2	200	19/26	19/26
CHE-817.3	350	19/26	19/26

CHE-818

CONDENSER, SPIRAL, GRAHAM

Borosilicate glass

	Effective Length, mm	Socket	Cone
CHE-818.1	150	14/23	14/23
CHE-818.2	250	19/26	19/26
CHE-818.3	300	24/29	24/29

CHE-819

CONDENSER, ALLIHN'S

Borosilicate glass

	Effective Length, mm	Socket	Cone
CHE-819.1	200	-	19/26
CHE-819.2	300	19/26	19/26

CHE-820

CONDENSER, COLD FINGER

Borosilicate glass, effective length 120 mm, Cone 14/23.

CHE-821

SOXHLET EXTRACTOR ASSEMBLY

Borosilicate glass, interchangeable joints, comprising Soxhlet extractor, Allihn's condenser and flask.

	Extractor Cap, ml	Extractor socket	Flask cone ml	Flask cape ml	Condenser effective length, mm
CHE-821.1	20	24/29	19/26	50	200
CHE-821.2	60	34/35	24/29	150	200
CHE-821.3	100	40/38	24/29	250	200
CHE-821.4	200	34/35	24/29	500	300

CHE-822

FLASK, BOILING

Borosilicate glass, short neck.

	Capacity, ml	Socket
CHE-822.1	5	10/19
CHE-822.2	50	14/23
CHE-822.3	100	14/23
CHE-822.4	150	24/29
CHE-822.5	250	24/29

CHE-823

FLASK, BOILING

Borosilicate glass, medium neck, socket 24/29.

	Capacity, ml	Socket
CHE-823.1	100	
CHE-823.2	250	
CHE-823.3	500	
CHE-823.4	1000	
CHE-823.5	2000	

CHE-824

FLASK, BOILING

Borosilicate glass two neck, centre socket 24/29, side socket 14/23 Capacity 1000 ml.

CHE-825

FLASK, BOILING

Borosilicate glass three neck, centre socket 24/29, side socket 14/23 Capacity 500 ml.

CHE-826

FLASK, CONICAL

Borosilicate glass.

	Capacity, ml	Socket
CHE-826.1	50	14/23
CHE-826.2	100	14/23
CHE-826.3	250	19/26
CHE-826.4	500	24/29



CHE-814



CHE-815



CHE-817





CHE-822

CHE-826.5 1000 24/29

CHE-827
FLASK, FILTER, BUCHNER
Borosilicate glass, conical.

	Capacity, ml	Socket
CHE-827.1	100	19/26
CHE-827.2	250	24/29
CHE-827.3	500	24/29
CHE-827.4	500	29/32

CHE-828
FLASK, PEAR SHAPE
Borosilicate glass, single neck.

	Capacity, ml	Socket
CHE-828.1	25	10/19
CHE-828.2	50	14/23
CHE-828.3	100	14/23

CHE-829
FLASK, PEAR SHAPE, TWO NECK
Borosilicate glass, with one centre neck and one angled side neck, centre socket 14/23 side socket 14/23. Capacity 50 ml.

CHE-830
FLASK PEAR SHAPE THREE NECK
Borosilicate glass, with one centre neck, one angled side neck and one parallel side neck.

	Capacity, ml.	Centre Socket	Side Socket
CHE-830.1	25	10/19	10/19
CHE-830.2	50	14/23	14/23

CHE-831
FUNNEL SEPARATING
Borosilicate glass, cylindrical type, with socket 19/26.

	Capacity, ml.
CHE-831.1	50
CHE-831.2	100

CHE-832
AIR LEAK TUBE
Borosilicate glass.

	Cone
CHE-832.1	10/19
CHE-832.2	14/23

CHE-833
CONE, WITH BENT STEM
Borosilicate glass.

	Cone
CHE-833.1	10/19
CHE-833.2	19/26

CHE-834
STOPPER
Borosilicate glass.

	Cone
CHE-834.1	10/19
CHE-834.2	14/23
CHE-834.3	19/26
CHE-834.4	24/29

CHE-835
REDUCTION ADAPTOR
Borosilicate glass.

	Socket	Cone
CHE-835.1	14/23	19/26
CHE-835.2	19/26	24/29
CHE-835.3	19/26	34/35



CHE-823



CHE-826



CHE-828



CHE-835.4 19/26 40/38

CHE-836
EXPANSION ADAPTOR
Borosilicate glass.

	Socket	Cone
CHE-836.1	19/26	14/23
CHE-836.2	24/29	14/23
CHE-836.3	24/29	19/26

CHE-837
ADAPTOR
Borosilicate glass, T-piece connection, socket 14/23, cone 14/23.

CHE-838
PLAIN BEND,
Borosilicate glass,

	Socket	Cone
CHE-838.1	19/26	19/26
CHE-838.2	24/29	19/26
CHE-838.3	24/29	24/29
CHE-838.4	34/35	34/35

CHE-839
BEND WITH VENT
Borosilicate glass, receiver adaptor, socket 10/19, cone 10/19

CHE-840
STILLHEAD, PLAIN
Borosilicate glass, with thermometer socket and matching cones for flask and condenser.

	Cone to fit flask	Cone to fit condensers	Thermometer pocket
CHE-840.1	10/19	10/19	10/19
CHE-840.2	14/23	14/23	14/23
CHE-840.3	19/26	19/26	19/26

CHE-841
THERMOMETER POCKET
Borosilicate glass, cone 14/23 closed end type.

CHE-842
DRYING TUBE
Borosilicate glass, bent type. Cone 14/23.

OVENS

CHE-843
UNIVERSAL OVEN
For heating upto 250° C inside chamber made of thick aluminium and stainless steel sheet. Outside made of Mild steel the gap between the walls being filled with glass wool. Heating elements are placed in ribs at the bottom and sides of chamber for uniform heating. Thermostatic control is provided which gives a temperature fluctuation of not more than ± 1 °C ready by an L shape thermometer. The insulated door closed firmly against heat resistant gasket and is provided with a handle with spring latch. Front panel has ON/OFF switch, 2 neon indicators and dial for temperature setting. unit provided with 1.5 ml of 3 core cable. Works on 220 - 240 V.A.C.

Size inside	No. of shelves	Aluminium	Stainless steel
300X300X300	2	CHE-843.1	CHE-843.6
350X350X350	2	CHE-843.2	CHE-843.7
450X600X450	2	CHE-843.3	CHE-843.8
600X600X600	2	CHE-843.4	CHE-843.9
600X900X600	3	CHE-843.5	CHE-843.10

CHE-844
OPTIONAL ACCESSORIES
Can be fitted to any above size, to be ordered along with the oven.

CHE-844.1	Timer
CHE-844.2	Air circulating fan
CHE-844.3	Digital temperature indicator



CHE-829



CHE-833



CHE-837



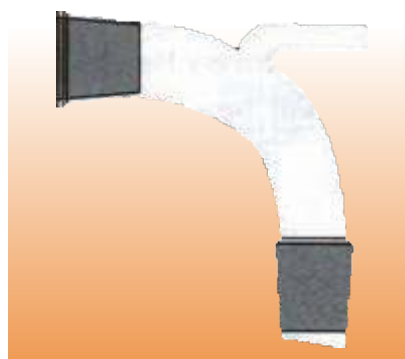

CHE-839

CHE-844.4 Digital temperature controller cum indicator

CHE-845

MUFFLE FURNACE

Working Temperature 940°C Maximum temperature 1000°C. Fitted with energy regulator, thermocouple and Pyrometer.

CHE-845.1	225 x 100 x 100 mm	(9" x 4" x 4")
CHE-845.2	250 x 125 x 125 mm	(10" x 5" x 5")
CHE-845.3	300 x 125 x 125 mm	(12" x 5" x 5")
CHE-845.4	300 x 150 x 150 mm	(12" x 6" x 6")

CHE-846

MUFFLE FURNACE (INDUSTRIAL USE)

Maximum Temperature range up to 1150 °C. Working temperature range 1100 °C with grooved refractories. Fitted with Sunvic Energy Regulator. Thermocouple complete with Pyrometer.

CHE-846.1	225 x 100 x 100 mm	(9" x 4" x 4")
CHE-846.2	300 x 125 x 125 mm	(12" x 5" x 5")
CHE-846.3	300 x 150 x 150 mm	(12" x 6" x 6")
CHE-846.4	300 X 200 X 200 mm	(12" x 8" x 8")

CHE-847

PH METER SENSOR, DIGITAL

For laboratory work 0 to 14 pH with resolution of 0.005 pH. accuracy ± 0.1 pH 0- 2000 mV with resolution of 1 mV $\pm 0.2\%$ reading on 3 1/2 digit LED display. Temperature compensation 0 to 100 °C standardization and slope adjustment present control for recalibration 230 V $\pm 10\%$. Connects to interface with auto identification. Includes soaking bottle storage solution.

PIPETTES

CHE-848

PIPETTE

Routine quality bulb form with one mark.

	Capacity, ml
CHE-848.1	1
CHE-848.2	2
CHE-848.3	5
CHE-848.4	10
CHE-848.5	50
CHE-848.6	100

CHE-849

PIPETTE GLASS

Glass B accuracy, bulb form with one mark on upper stem

Capacity, ml	Neutral glass	Borosilicate glass
1	CHE-849.1	CHE-849.7
2	CHE-849.2	CHE-849.8
5	CHE-849.3	CHE-849.9
10	CHE-849.4	CHE-849.10
50	CHE-849.5	CHE-849.11
100	CHE-849.6	CHE-849.12

CHE-850

PIPETTE

Glass, serological graduated to tip to deliver total capacity when last drop is blown out, colour coded.

Capacity, ml	Sub division, ml	Neutral glass	Borosilicate glass
1	0.01	CHE-850.1	CHE-850.6
2	0.02	CHE-850.2	CHE-850.7
5	0.05	CHE-850.3	CHE-850.8
10	0.01	CHE-850.4	CHE-850.9
25	0.02	CHE-850.5	CHE-850.10

CHE-851

PIPETTE, PASTEUR

Soda glass, disposable without treat.

CHE-852

PIPETTE, DROPPING

Pipette with rubber teat length approx 40 mm

CHE-853

TEATS FOR PIPETTE

Rubber, with rolled edges for use with dropping pipettes pack of 100.

CHE-854

PIPETTE BULB

Made of rubber, with thick walled neck



CHE-843



CHE-845



CHE-855

PIPETTE FILLER

Comprises a rubber bulb and three pinch valves, for use with pipettes upto 50 ml.

CHE-856

PIPETTE STAND POLYPROPYLENE

To hold 12 pipettes horizontally.

CHE-857

PIPETTE STAND POLYPROPYLENE

To hold 28 pipettes vertically.

CHE-858

PIPETTE STERILIZING BOX

Accommodates pipettes vertically. Stainless steel, tall cylindrical can with lid size 350 x 50 mm.

CHE-859

PNEUMATIC TROUGH

Glass, circular

	Dia, mm	Ht, mm
CHE859.1	150	100
CHE-859.2	200	100
CHE-859.3	250	100
CHE-859.4	300	125
CHE-859.5	300	150

CHE-860

PNEUMATIC TROUGH POLYPROPYLENE

made of Polypropylene, Autoclavable.

	Dia, mm
CHE860.1	180
CHE-860.2	200
CHE-860.3	250

POLARIMETERS

CHE-861

LAURENT'S HALF SHADE POLARIMETER

Suitable for determining specific rotation of optically active substances. It has Laurent's quartz half shade device which makes the system sufficiently accurate and at the same time simple suitable for use with sodium light. The circular head is attached near to the analyzer. Vernier movable over the scale enables reading upto 0.1 ° A 200 mm tube is provided with the instrument. Mounted on a sturdy tripod stand. Adjustable for height.

CHE-862

POLARIMETER, SENIOR

Designed to accept observation tube upto 220 mm length. Its improved rotating half shadow system at the front ensures perfect focus and clear definition. With angular glass scale 0-360 ° divided into degrees and reading upto 0.05 with micrometer A sugar scale from 30 to 120 ° reads up to 0.1 sugar degree. Supplied complete with two polarimeter tubes. 100 mm and 200 mm, and dust cover.

CHE-863

POLARIMETER TUBE

Borosilicate glass, with brass ends

CHE-863.1	100 mm
CHE-863.2	200 mm

PUMPS

CHE-864

AIR PUMP

Vacuum or pressure, hand operated supplied as vacuum pump but can be readily converted to pressure pump by reversing piston head and valve.

CHE-865

AIR PUMP ON WOODEN BASE

Single action, metal pump barrel with piston and wooden handle attached to metal plate of 200 mm dia. with stopcock. air inlet screw and connection for tubing on wooden base.

CHE-866

RETORT



CHE-847



CHE-850



CHE-856



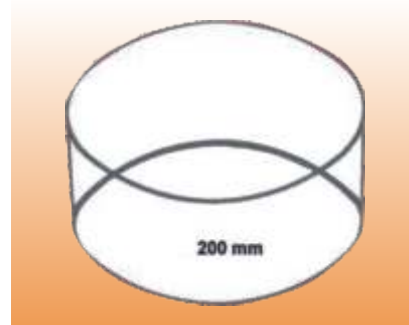

CHE-859

Borosilicate glass, with interchangeable stopper.

CHE-866.1	250 ml
CHE-866.2	500 ml
CHE-866.3	1000 ml

REFRACTOMETERS

CHE-867

REFRACTOMETER, HAND

Convenient to use. The built in ocular scale gives direct reading for percentage of sugar density Accuracy 0.2%.

	Range
CHE-867.1	0 to 32%
CHE-867.2	28 to 62%
CHE-867.3	58 to 90 %

REFRACTOMETER, ABBE

For quick examination of refractive indices and mean dispersion of liquids, solids, and powders. Comprising Abbe double prisms, with thermostat, compensator, telescope mirror and radial arm with vernier. Range nD 1.30000 to nD 1.70000 in steps of 0.0001 sugar percentage 0 to 95% in steps of 1 division.

SAFETY EQUIPMENTS

CHE-869

GLOVES

Asbestos, cotton lined with individual fingers and thumb. length 300 mm , pair.

CHE-870

GLOVES, LEATHER

To provide protection for hands and forearms against exposure to heat, pair.

CHE-871

GLOVES, VINYL

Vinyl Gloves. Multipurpose. For handling chemical substances. Pack of 100

CHE-872

GLOVES, RUBBER LATEX

General purpose, with raised surface pattern for wet grip, supplied in pairs

CHE-873

PROTECTIVE SUIT FOR HAZARDOUS ACTIVITIES

Protective Suits and coveralls for chemical and hazardous activities

CHE-874

SAFETY GOGGLES EYE

Light weight, mounted in moulded frame with side shields. Eyes protection from chemical reagents.

CHE-875

SAFETY SHIELD

Safety Shield facial for hazardous substances.

CHE-876

SILICON GREASE

Silicon grease for Laboratory Glassware



CHE-861

SHAKERS

CHE-877

SHAKER, FLASK

Wrist action, robust with AC/DC universal motor, to hold 4.6 or 8 flasks form 100 ml to 500 ml capacity.

CHE-878

SIEVES

200 mm dia, polished seamless brass frame each sieve is marked with nominal aperture. Steel mesh.

	Mesh mm		Mesh mm
CHE-878.1	4.75	CHE-878.8	0.355
CHE-878.2	2.00	CHE-878.9	0.300
CHE-878.3	1.70	CHE-878.10	0.250
CHE-878.4	1.00	CHE-878.11	0.212
CHE-878.5	0.710	CHE-878.12	0.150
CHE-878.6	0.600	CHE-878.13	0.125

CHE-878.7 0.425 CHE-878.14 0.106

CHE-879

SIEVE SHAKER, HAND OPERATED

Accommodates upto 6 sieves of 200 mm dia with lid and receiver. Operated by a hand wheel. A heavy flywheel ensures smooth operation.

CHE-880

SIEVE SHAKER, MOTORIZED, GYRATORY

Gyratory Sieve Shaker is driven by ¼ H.P. Electric motor through a reduction gear, can carry upto SIX, 6" OR 8" /12" /18" Test Sieves, works on 220 Volts 50 Hz. Supply.

CHE-878

SHAKING MACHINE, RECIPROCATING, KAHN TYPE

Complete with carrier for flasks, test tube racks, bottles, etc. Speed is unaffected by normal line voltage fluctuations or loading within specified limits, 0.25 HP motor, speed 275 strokes per minute. Carrier size 500 x 325 x 100 mm.



CHE-868

SPATULA

CHE-882

SPATULA POLYPROPYLENE

Moulded in Polypropylene, spatula consist of a spoon on one side while the other end is a flat construction with a knife edge

CHE-882.1	150 mm
CHE-882.2	200 mm

CHE-883

SPATULA, STAINLESS STEEL

Stainless steel, one end flat, other end spoon form

	Length, mm
CHE-883.1	120
CHE-883.2	150



CHE-873

STANDS

CHE-884

BASE FOR RETORT STAND

Cast iron, with tapped hole, stove enamelled.

	Size, mm
CHE-884.1	150 X 100
CHE-884.2	200 X 125
CHE-884.3	250 X 150
CHE-884.4	300 X 200

CHE-885

RETORT STAND

Stove enamelled, with chrome plated mild steel rod.

	Base size mm	Rod length mm	Rod Dia mm
CHE-885.1	150X100X4	500	9
CHE-885.2	175X125X4	600	9
CHE-885.3	200X125X4	600	12
CHE-885.4	225X150X4	750	12
CHE-885.5	300X175X4	750	12



CHE-874

CHE-886

RETORT STAND POLYPROPYLENE

Moulded Retort Stand, Non Corrosive, The rod measuring 12.5 mm x 750 mm can be screwed into heavy base of size 300 x 200 mm

CHE-887

CLAMP

Pressed metal, cork lined jaws, can open upto 50 mm.

CHE-887.1	Black painted
CHE-887.2	Chrome plated

CHE-888

UNIVERSAL CLAMP

Aluminium alloy, other parts are of plated brass, cork lined, ensures firm grip at all angles of opening, opens upto 90 mm with 250 x 8 mm nickel plated mild steel rod.



CHE-875





CHE-878

CHE-889
CLAMP 3 PRONG
Die cast aluminium, with plated brass inserts, accepts articles upto 70 dia rubber, covered jaws.

CHE-890
BURETTE CLAMP
Aluminium with steel rod, cork, lined jaws for holding burettes and other objects of dia upto 60 mm.

CHE-891
BOSS
Mild steel, die pressed chrome plated can hold stand rod upto 18 mm dia and clamp rod upto 10 mm dia.

CHE-892
BOSS
Cast iron, stove enamelled with nickel plated clamping screws, can accommodate rods upto 12 mm.

CHE-893
BOSS, SWIVEL
Aluminium alloy holds rods upto 12 mm, swivels and locks at any angle.

CHE-894
BOSS
Aluminium alloy, with offset jaws, nickel plated brass clamping screws, to hold rods upto 16 mm dia, withstands heavy clamping pressure.

CHE-895
RETORT STAND RING
Iron, with stem.

	Dia, mm
CHE-895.1	50
CHE-895.2	75
CHE-895.3	100

CHE-896
RETORT STAND RING
Iron, with integral boss to accept rods upto 12 mm, dia Boss is fitted with a plated thumb screw.

	Dia, mm
CHE-896.1	50
CHE-896.2	75
CHE-896.3	100

STIRRERS

CHE-897
STIRRER
1/20 H.P. 4000 rpm with stainless steel shaft 250 x 6 mm, having a single 3 bladed propeller threaded chock of 6.5 mm capacity for quick interchangeability of shaft shaving maximum dia upto 6.5 mm . Electronic speed regulator, capacity for liquids 5 to 7 litres, mounted on stand.

CHE-898
MAGNETIC STIRRER WITH HOT PLATE
Capacity 2 litres ,For simultaneous heating and stirring of solutions. A cast aluminium hot plate is mounted above a variable speed magnetic stirrer. An energy regulator for the hot plate. On/off switch and rotary speed control for the stirrer motor together with neon lamp s are mounted on the front panel. Supplied complete with teflon coated stirrer bar. For use on 220-240 , 50 Hz.

RUBBER STOPPERS

CHE-899
RUBBER STOPPERS
With number moulded in on each piece. Dimensions are approximate.

	No	Bottom dia, mm	Top dia, mm	Ht, mm
CHE-899.1	000	6	9	16
CHE-899.2	00	7	10	16.5
CHE-899.3	0	9	13	15.5



CHE-889



CHE-899.4	1	11	14	18.5
CHE-899.5	2	13	16.5	20
CHE-899.6	3	14	19	21
CHE-899.7	4	15	21	22
CHE-899.8	5	17.5	22.5	23
CHE-899.9	6	20	24.5	24
CHE-899.10	7	20	26	27.5
CHE-899.11	8	21	26.5	27.5
CHE-899.12	9	21.5	28	31
CHE-899.13	10	26	30	33
CHE-899.14	11	30	33.5	33.5
CHE-899.15	12	30	34.5	34.5
CHE-899.16	13	31	38.5	37
CHE-899.17	14	32	41.5	42.5
CHE-899.18	15	34	43.5	40.5
CHE-899.19	16	35.5	45	36.5
CHE-899.20	17	40	49.5	40.5
CHE-899.21	18	48	53.5	33.5
CHE-899.22	19	44.5	58	45
CHE-899.23	20	51	60	56.5
CHE-899.24	21	60	70	50

Can also be available with One hole and Two Holes at extra cost.

TEST PAPERS

CHE-900
LITMUS TEST PAPER
Book of 100 leaves. Blue

CHE-901
LITMUS TEST PAPER
Book of 100 leaves. Red

CHE-902
PH INDICATOR PAPER
PH indicator paper, universal pH 1-10 including colour scale, pack of 100 leaves.

CHE-903
pH INDICATOR PAPER
Universal pH 1 to 14 including colour scale book of 20 leaves.

TEST TUBES

CHE-904
TEST TUBE
Neutral glass.

With rim	Without rim	Size, mm
CHE-904.1	CHE-904.5	75 x 12
CHE-904.2	CHE-904.6	100 x 12
CHE-904.3	CHE-904.7	125 x 15
CHE-904.4	CHE-904.8	150 x 18

CHE-905
TEST TUBE
Borosilicate glass, medium wall

With rim	Without rim	Size, mm
CHE-905.1	CHE-905.12	75 x 12
CHE-905.2	CHE-905.13	75 x 12
CHE-905.3	CHE-905.14	100 x 12
CHE-905.4	CHE-905.15	125 x 15
CHE-905.5	CHE-905.16	150 x 15
CHE-905.6	CHE-905.17	150 x 18
CHE-905.7	CHE-905.18	100 x 25
CHE-905.8	CHE-905.19	150 x 25
CHE-905.9	CHE-905.20	200 x 25
CHE-905.10	CHE-905.21	200 x 32
CHE-905.11	CHE-905.22	200 x 38

CHE-906
TEST TUBE
Borosilicate glass, with side arm.



CHE-892



CHE-898



CHE-899





CHE-899

	Size, mm
CHE-906.1	125X15
CHE-906.2	150X18
CHE-906.3	150X25

CHE-907
CULTURE TUBE, MEDIA
Borosilicate glass, round bottom, with screw cap and rubber liner.

	Capacity, ml.	Size, mm
CHE-907.1	5	75X16
CHE-907.2	10	125X16
CHE-907.3	30	100X25
CHE-907.4	60	200X25

CHE-908
CULTURE TUBE, MEDIA
Borosilicate glass, flat bottom with screw cap, and rubber liner.

	Capacity, ml.	Size, mm
CHE-908.1	5	50X16
CHE-908.2	15	57X25
CHE-908.3	30	95X25

CHE-909
IGNITION TUBE
Hard glass, 50 x 6 mm pack of 144.

CHE-910
TEST TUBE HOLDER
Wood, with steel spring for closing jaws, length, 180 mm approx for 11-19 dia tubes.



CHE-904

CHE-911
TEST TUBE HOLDER
Metal strips with a slider, mounted in wooden handle.

CHE-911.1	Brass
CHE-911.2	Plated steel

CHE-912
TEST TUBE HOLDER, CROSS PATTERN
Stout brass strips mounted in wooden handle to hold tubes from 12 mm to 40 mm. Overall length 220 mm.

CHE-913
TEST TUBE HOLDER
Plated spring steel wire with finger grip, with a wire collar to hold steel tubes upto 38 mm.

	Holes 22 mm	Holes 32 mm	Pegs
CHE-914.1	4	2	-
CHE-914.2	6	2	-
CHE-914.3	10	2	12

CHE-915
TEST TUBE STAND
Pack flat type, wooden top and bottom with moulded polypropylene supports.

	Holes 22 mm	Holes 32 mm	Pegs
CHE-915.1	4	2	-
CHE-915.2	4	2	6
CHE-915.3	10	2	-
CHE-915.4	10	2	12

CHE-916
TEST TUBE STAND POLYPROPYLENE
Autoclavable Six Holes Most commonly used Test tube stand in various laboratories. The top plate has 2 holes to hold Test tubes 25 mm dia and four holes to hold Test tube of 16 mm dia. It has six vertical pins for drying tubes.

CHE-917
TEST TUBE STAND POLYPROPYLENE (ROUND)



CHE-905



A handy and space saver, The stand has Four 25 mm dia holes & eight 19 mm holes in its Top plate with 16 vertical pins for drying the tubes.

CHE-918
TEST TUBE STAND POLYPROPYLENE (3 TIER)
Autoclavable racks with three tier design.

CHE-918.1	20 mm x 20 Tubes
CHE-918.1	25 mm x 18 Tubes

CHE-919
TEST TUBE STAND
Aluminium made from thick anodized aluminium sheet. in three tiers.

CHE-919.1	10 mm x 18 holes
CHE-919.2	10 mm x 24 holes
CHE-919.3	12 mm x 18 holes
CHE-919.4	12 mm x 24 holes
CHE-919.5	18 mm x 18 holes
CHE-919.6	18 mm x 24 holes
CHE-919.7	25 mm x 18 holes
CHE-919.8	25 mm x 24 holes

THERMOMETERS

CHE-920
THERMOMETER
76 mm immersion type, mercury in glass white enamelled back, engraved stem length 300 mm approx. in card board case.

	Range	Sub-division
CHE-921.1	-10 to 50 ° C	0.5 ° C
CHE-921.2	-10 to 110 ° C	1 ° C
CHE-921.3	-10 to 360 ° C	2 ° C
CHE-921.4	0 to 220 ° C	1 ° F
CHE-921.5	0 to 220 ° F	1 ° F
CHE-921.6	0 to 600 ° F	2 ° F

CHE-922
THERMOMETER
Total immersion type, mercury in glass, white enamelled back, engraved short stem 150 mm long.

	Range	Sub-division C°
CHE-922.1	-10 to 50	1
CHE-922.2	-10 to 110	1
CHE-922.3	-10 to 250	2
CHE-922.4	-10 to 360	5

CHE-923
THERMOMETER
76 mm immersion type, length approx 300 mm red colour alcohol filled white enamelled back.

	Range	Sub-division C°
CHE-923.1	-10 to 50	1
CHE-923.2	-10 to 110	1

CHE-924
THERMOMETER, CLINICAL
Permanent fused scale, with constriction in bore to prevent mercury from going back in case.

CHE-924.1	35 ° C to 42 ° C for oral use.
CHE-924.2	95 ° F to 108. 6 ° F, Oral use.
CHE-924.3	95 ° F to 108. 6 ° F, rectal use.

CHE-925
THERMOMETER, MAXIMUM AND MINIMUM
Six's type mercury alcohol filled dual scale with resetting magnet.

CHE-926
RAIN GAUGE
Made of Brass More durable It has a 130 mm Funnel an inner receiving vessel and a outer body all of Brass with a polythene Measuring Cylinder.



CHE-907



CHE-911



CHE-914

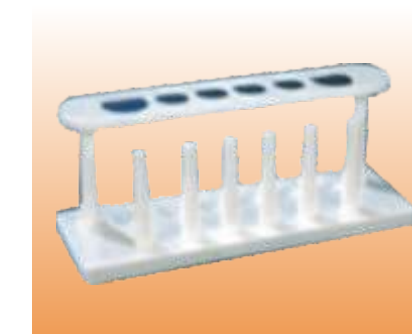

CHE-916



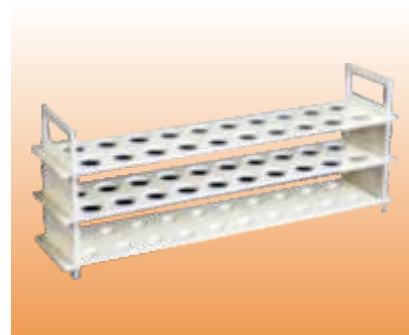

CHE-918

CHE-927

HYGROMETER, DRY AND WET BULB

Two thermometers mounted on scales -10 to 60°C and -20 to 140 °F with water container for one thermometer. Complete with relative humidity table.

CHE-927.1 in metal case

CHE-927.2 On polished graduated wooden base.

CHE-928

WHIRLING HYGROMETER, DRY AND WET

Two thermometers mounted in frame, fitted with a handle enabling the frame to be rotated in carrying case.

CHE-928

THERMOMETER, WALL

With scale reading from -20 °C to 50 °C X 1 °C and 0 to 120 °F x 2 °F with bulb guard, prismatic tube for easy reading.

CHE-929

SPHYGNOMANOMETER / B.P. APPARATUS

CHE-929.1 Mercurial type

CHE-929.2 Dial type

TIMERS

CHE-930

STOP CLOCK

With start stop and reset actions 100 mm dia, dial graduated in seconds, figured every 5 seconds.

CHE-931

STOP WATCH

With start, stop and reset actions, all through the winding knob.

CHE-931.1 Reading 1/5 of a second

CHE-931.2 Reading 1/10 of a second

TONGS

CHE-932

CRUCIBLE TONGS

Jaws corrugated inside.

	With bow	Type	Length, mm
CHE-932.1	CHE-932.7	Iron, plated	150
CHE-932.2	CHE-932.8	Iron, plated	200
CHE-932.3	CHE-932.9	Iron, black	150
CHE-932.4	CHE-932.10	Iron, black	200
CHE-932.5	CHE-932.11	brass, plated	150
CHE-932.6	CHE-932.12	brass, plated	200

CHE-933

BEAKER TONGS

Stainless steel, jaws covered with asbestos, can firmly hold any beaker from 250 ml to 1000 ml.

	Length, mm
CHE-933.1	250
CHE-933.2	300

CHE-934

FLASK TONGS

Stainless steel cork lined rectangular jaws.

CHE-934.1	250 mm
CHE-934.2	300 mm

CHE-935

PIPE CLAY TRIANGLE

Pipeclay stems on iron wire.

	Length, mm
CHE-935.1	50
CHE-935.2	65

CHE-936

TRIPOD STAND

Triangular top of cast iron, with steel legs bent outwards for stability painted.

Length of	Ht, mm
-----------	--------

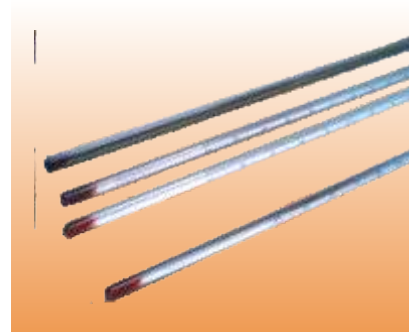

CHE-923



CHE-926



	one side, mm	
CHE-936.1	100	150
CHE-936.2	125	200

CHE-937

TRIPOD STAND, STEEL

Triangular top, all steel welded legs bent outward for stability. Length of one side 130 mm, height 200 mm.

CHE-938

TRIPOD STAND, CIRCULAR

Cast iron top

	Dia, mm	Ht, mm
CHE-938.1	100	150
CHE-938.2	125	200

TUBING

CHE-939

TUBING, GLASS

Outer dia 4 to 10 mm, bundle of 5 kg of any one size.

CHE-939.1	Soda glass
CHE-939.2	Neutral glass

CHE-940

TUBING GLASS

Borosilicate glass, bundle of 1 kg.

	O.D., mm
CHE-940.1	6
CHE-940.2	10

CHE-941

TUBING, CAPILLARY

Neutral glass, assorted sizes, bore 1 mm to 6 mm bundle of 5 kg.

CHE-942

TUBING CAPILLARY

Borosilicate glass, nominal length 1.5 meter

	O.D., mm	Bore, mm
CHE-942.1	5.5	0.5
CHE-942.2	6.5	1.0
CHE-942.3	6.5	1.5

CHE-943

TUBE, COMBUSTION

Borosilicate glass, both ends open length 300 mm.

	O.D., mm	Bore, mm
CHE-943.1	16	11
CHE-943.2	22	16
CHE-943.3	25	17

CHE-944

TUBE, COMBUSTION

Borosilicate glass, with a small hole near lower end of the tube.

CHE-945

RUBBER TUBING, RED

For general laboratory use, roll of 10 meter length,

	Bore mm	Wall thickness (mm)
CHE-945.1	4	1.0
CHE-945.2	8	1.5
CHE-945.3	10	2.0
CHE-945.4	12	2.5

CHE-946

RUBBER TUBING, PRESSURE

	Bore mm	Wall thickness (mm)
CHE-946.1	3.0	3.0
CHE-946.2	6.0	3.0
CHE-946.3	10.0	3.5

CHE-947



CHE-929



CHE-930



CHE-931

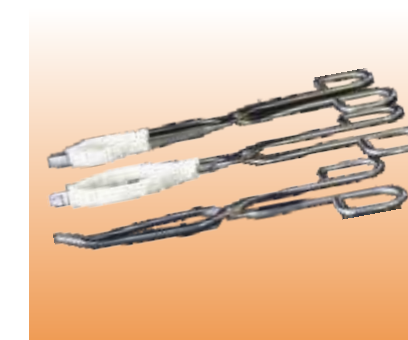

CHE-933





CHE-936

RUBBER TUBING, HIGH PRESSURE

	Bore mm	Wall thickness (mm)
CHE-947.1	3.0	4.5
CHE-947.2	4.5	4.5
CHE-947.3	8.0	4.5

CHE-948**TUBING PVC**

Transparent medium wall tough, and flexible resistant to acids and alkalis coils of 10 meters.

	Bore mm	Wall thickness (mm)
CHE-948.1	3.0	4.5
CHE-948.2	4.5	4.5
CHE-948.3	8.0	4.5

CHE-949**TUBING SILICON RUBBER**

	Bore mm	Wall thickness mm
CHE-949.1	3.0	4.5
CHE-949.2	4.5	4.5
CHE-949.3	8.0	4.5

CHE-950**TUBING ACRYLIC**

Strong, rigid, transparent, bore 25 mm.

	Length mm
CHE-950.1	300
CHE-950.2	1000

CHE-951**TUBING CONNECTORS**

Polypropylene, three way rifled ends.

CHE-951.1	T-shape
CHE-951.2	Y-shape

CHE-952**VERNIER MICROSCOPE**

For measurement on two axes, with horizontal and vertical scales, heavy stand with levelling screws and a carriage fitted with micrometer screw for fine adjustment. Another sliding carrier is provided on vertical bar also with micrometer screw for fine adjustment. Microscope tube is fitted with rack and pinion focussing. Stainless steel scales and verniers, horizontal scale 160 mm with vernier reading to 0.01 mm and vertical scale reading 140 mm with vernier reading to 0.01 mm. Ramsden eye piece X10 S10 with crossline graticule and 50 mm focus objectives Magnifier is provided to read vernier.

CHE-953**VERNIER MICROSCOPE**

For Newton Ring Apparatus. Can also be used in various position, heavy cast body, microscope tube mounted on a carriage sliding on top of the base, provided with fine adjustment screw, scale 120 mm long, vernier reading to 0.01 mm fitted with X 10 Ramsden eye piece, glass cross line graticule and 75 mm focus achromatic objective.

CHE-954**WATCH GLASS**

Concave, with ground edge.

	Dia, mm
CHE-954.1	50
CHE-954.2	75
CHE-954.3	100

CHE-955**WATCH GLASS**

Borosilicate glass, concave fire polished edge.

	Dia, mm
CHE-955.1	75
CHE-955.2	100
CHE-955.3	125
CHE-955.4	150

CHE-956**WATER DISTILLER, MANESTY TYPE**

Automatic, wall mounting, electrically heated. Designed to provide pyrogen free distilled water at low cost. All main parts like boiling chamber Lid, baffle, condenser tube are of stainless steel. The heating element has automatic cut out which cuts current off if water level falls. Easy to clean and reassemble. Complete with wall mounting bracket, electrical cord, connector etc. To work on 240 V, 50 Hz. Supplied



CHE-945



	Output litre/hr	Wattage, kW
CHE-956.1	1.5	1.5
CHE-956.2	2.5	2.5
CHE-956.3	4.0	4.0
CHE-956.4	6.0	6.0

CHEMICALS & REAGENTS

CHE-957	Acetic acid concentrated
CHE-958	Acetic acid glacial AR
CHE-959	Acetone AR
CHE-960	Acetonitrile AR
CHE-961	Adipic acid
CHE-962	Ammonium solution
CHE-963	Ammonium chloride
CHE-964	Barium carbonate AR
CHE-965	Barium chloride
CHE-966	Barium Nitrate
CHE-967	Barium Peroxide
CHE-968	Barium Sulphide
CHE-969	Bromo Cresol Green Powder
CHE-970	Cadmium Borate
CHE-971	Cadmium Iodide
CHE-972	Calcium hydroxide
CHE-973	Calcium sulphate
CHE-974	Citric Acid (Mono)
CHE-975	Clove oil
CHE-976	Cobalt Metal
CHE-977	Cobalt (II) carbonate
CHE-978	Copper (II) oxide
CHE-979	Copper (II) sulphate
CHE-980	Copper metal powder
CHE-981	Dextrose (Anhydrous)
CHE-982	Diethyl oxalate
CHE-983	Dimethyl acetamide
CHE-984	E. D. T. A. acid
CHE-985	Egg albumin powder
CHE-986	Ethyl acetate
CHE-987	Ethyl methyl ketone
CHE-988	Ferric nitrate
CHE-989	Ferric Sulphate
CHE-990	Formic Acid
CHE-991	Gelatin powder
CHE-992	Guargum powder
CHE-993	High vacuum silicon grease
CHE-934	Hydriodic AR
CHE-935	Hydrochloric acid concentrated
CHE-936	Indigo carmine AR
CHE-937	Iron Powder
CHE-938	Lacti acid
CHE-939	Lead metal
CHE-940	Manganese dioxide
CHE-941	Magnesium ribbon
CHE-942	Magnesium sulphate
CHE-943	Magnesium Nitrate AR
CHE-944	Methyl orange
CHE-945	Mercury metal
CHE-946	Nitric acid concentrated
CHE-947	Phenolphthalein
CHE-948	Potassium chlorate
CHE-949	Potassium dichromate
CHE-950	Potassium hydroxide
CHE-951	Santonite Powder (Aluminium Silicate Hydrate)
CHE-952	Silver nitrate
CHE-953	Sodium bicarbonate
CHE-954	Sodium carbonate
CHE-955	Sodium Sulphate
CHE-956	Sodium Nitrate
CHE-957	Sodium hydroxide
CHE-958	Sulphuric acid concentrated
CHE-959	Zinc commercial (pieces) bottle
CHE-960	Zinc sulphate
CHE-961	Zirconium dioxide AR

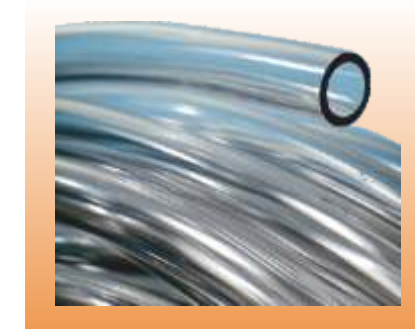

CHE-948



CHE-952

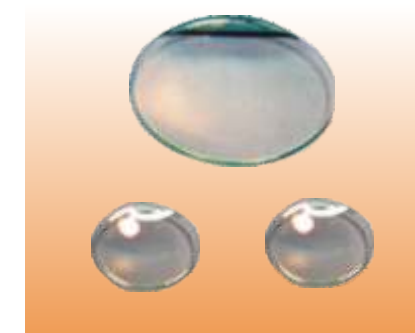

CHE-954



CHE-956



Note: The above list is only indicative all laboratory chemicals are available, kindly contact for price and list of chemicals.
All chemicals are available in small and bulk packing.

DEHYDRATED CULTURE MEDIA

CHE-962 AC Agar
 CHE-963 AC Broth
 CHE-964 Acetate Agar
 CHE-965 Alkaline peptone water
 CHE-966 Anaerobic Agar
 CHE-967 Antibiotic assay medium B
 CHE-968 Ashby's glucose agar
 CHE-969 Bile esculin agar
 CHE-970 Bile salts mixture
 CHE-971 Bio peptone
 CHE-972 Blood agar base
 CHE-973 Casein acid hydro lysate
 CHE-974 Columbia blood agar base
 CHE-975 D.C.L.S. agar
 CHE-976 Dextrose starch agar
 CHE-977 Diagnostic thiolglycollate medium
 CHE-978 Disinfectant test brothe
 CHE-979 Egg yolk emulsion
 CHE-980 Glucose yeast peptone agar
 CHE-981 Hugelison medium
 CHE-982 Inorganic salt medium
 CHE-983 KF sterptococcai agar base
 CHE-984 KF sterptococcai broth
 CHE-985 Malt extract agar base
 CHE-986 Maltodextrin powder
 CHE-987 Motality test medium
 CHE-988 Nitrate broth
 CHE-989 Peptone M
 CHE-990 Proteose peptone
 CHE-991 Seed agar
 CHE-992 Soyabean casein digest medium
 CHE-993 Triple sugar iron agar
 CHE-994 Tryptone agar
 CHE-995 Urea agar base
 CHE-996 Xylose lysine agar base
 CHE-997 Yeast extract agar
 CHE-998 Yeast mannitol broth

Note: The above list is only indicative all culture media are available, kindly contact for price and list of dehydrated culture media.

CHE-999

CONDUCTIVITY PROBE

Connects to interface with auto-indentification
 3 ranges : 0 to 100mg/L TDS, 0 to 1000mg/L TDS, and 0 to 2000mg/L TDS
 Automatic temperature compensation from 0 to 35C



CHE-999

